



Mechanical seeders and fertiseeder to save labor for direct seeded rice in the lowland and upland of Madagascar



Contacts:

- Kalimuthu Senthilkumar (k.senthilkumar@cgiar.org)
- Aina Andriatsiorimanana (a.andriatsiorimanana@cgiar.org)

Address: Africa Rice Center (AfricaRice), P.O. Box 1690, Antananarivo, Madagascar

Partner:

- Centre de Fabrication, de Formation et d'Application du Machinisme et de la Mécanisation Agricole



Seeders and fertiseeder description

Two types of mechanical seeders, specifically the CFFAMMA seeder (Figure 1A) and the New seeder (Figure 1B), were developed along with a fertiseeder (a manual seeder combined with a fertilizer micro-dose applicator) to save labor in direct seeded rice. The seeders are designed with a single row rotary mechanism for dibbling seeds, while the fertiseeder allows simultaneous dibbling of seeds and precise placement of fertilizer micro-doses.

Field trials were conducted in both lowland and upland conditions in Madagascar over two consecutive seasons in 2018 and 2019. Compared to manual seeding, the two manual seeders reduced labor requirements by 70-80%, while the fertiseeder reduced labor requirements by 83% when combined with micro-dose placement. Feedback from 222 farmers was considered to improve the Fertiseeder 1. These machines are now ready for scaling up.

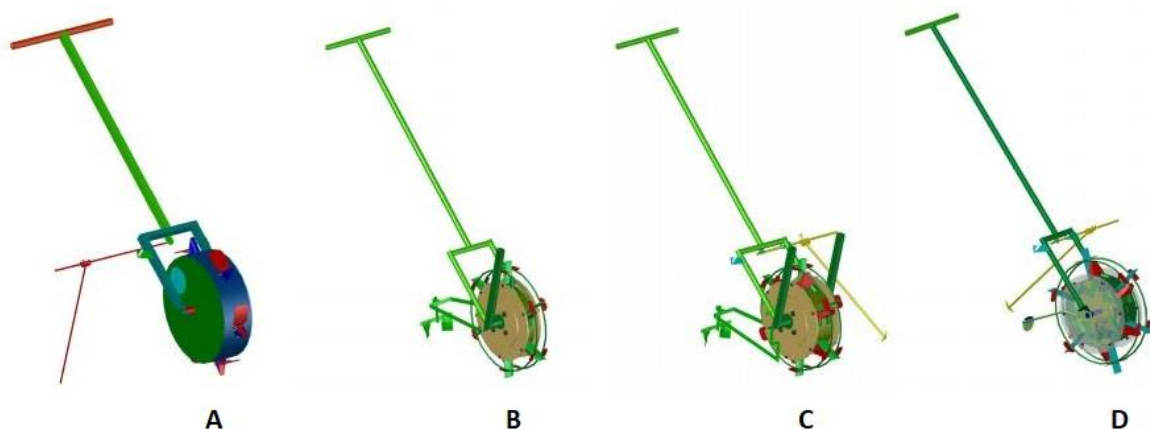
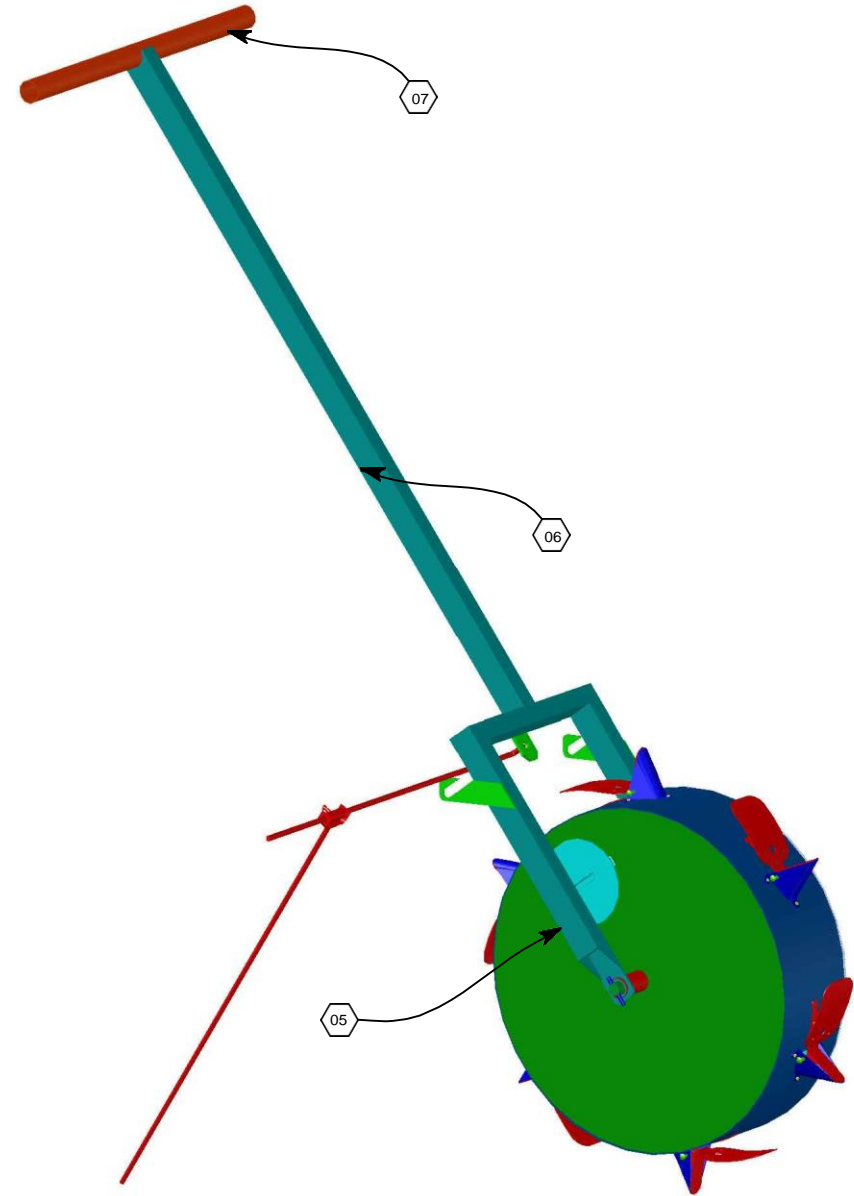
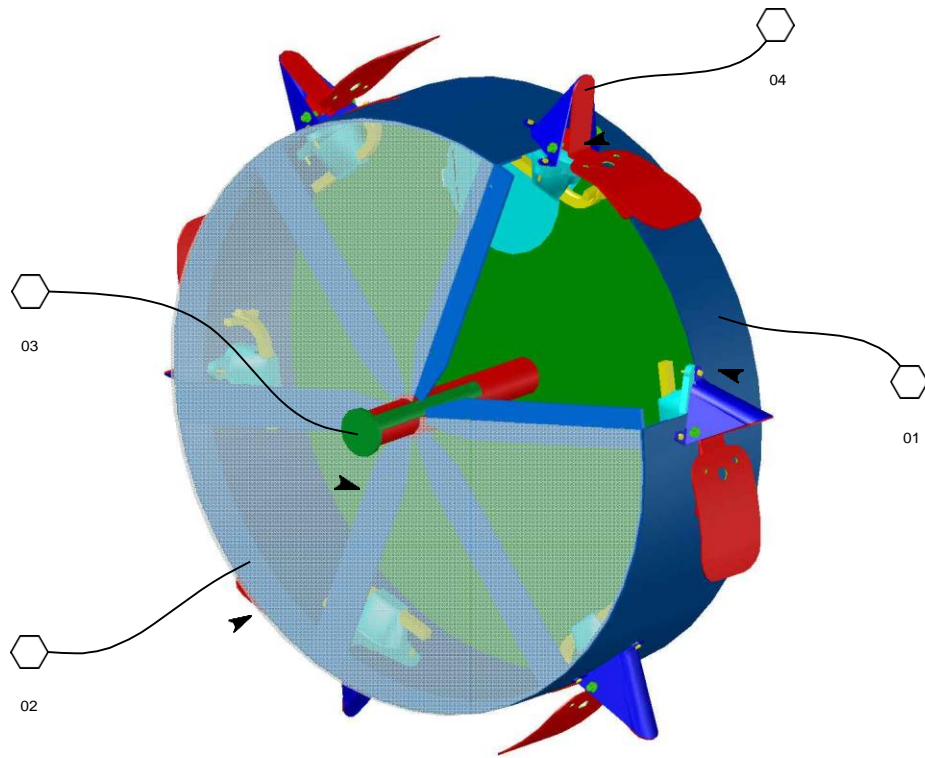



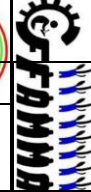

Figure 1. Technical drawings of CFFAMMA seeder (A), New seeder (B), Fertiseeder 1 (C) and Fertiseeder 2 (D).

For detailed technical drawings of the above seeders and fertiseeder, please refer to the following pages.

A- CFFAMMA SEEDER



07	Mancheron	1	Tube galva Ø20/27
06	Manche	1	Tube rect 30mm x 20 mm
05	Support manche	1	Tube rect 30mm x 20 mm
04	Bec	6	TPN 12/10
03	Axe	1	Fer rond Ø14
02	Plexiglass	1	4 mm
01	Tremis	1	TPN 12/10
N°	Nomination	nbr	Matière

	MINISTÈRE DE L'AGRICULTURE ET DE L'ÉLEVAGE Projet d'Amélioration de la Productivité Rizicole, de gestion des bassins versants et des périmètres Irrigués			
	Echelle : août 2018 Mahefa RASOLOHARISON			
	SEMOIR POUR RIZ PLUVIAL			Centre de Fabrication, de Formation et d' Application du Machinisme et de la Mécanisation Agricole

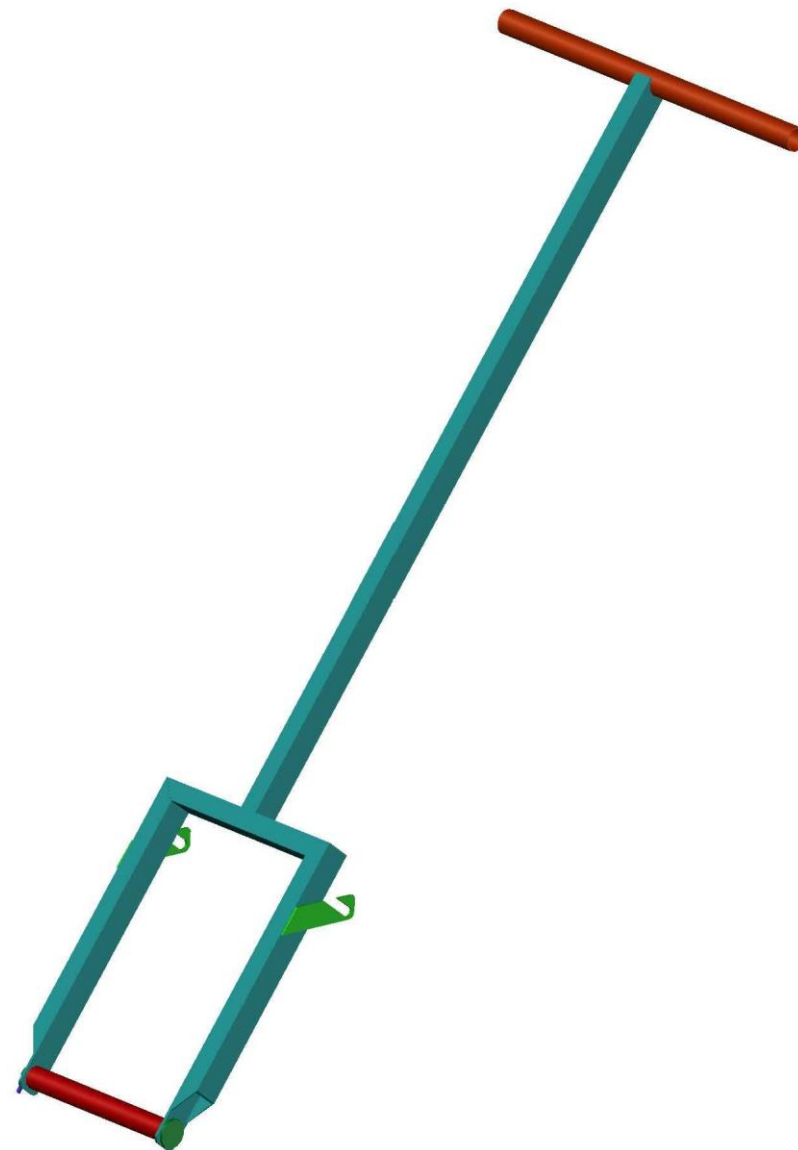
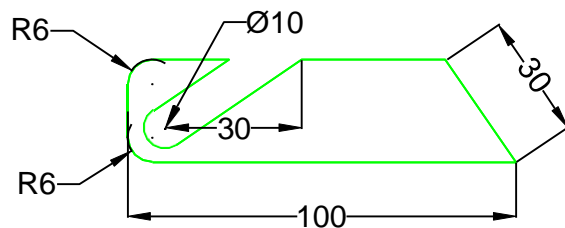
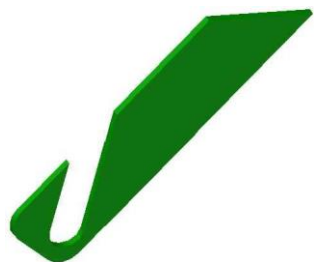
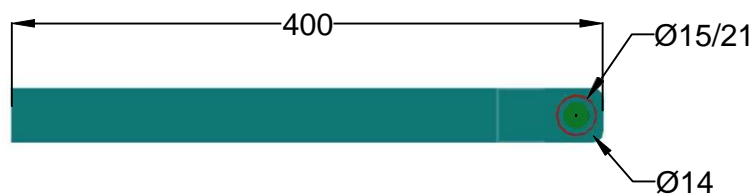
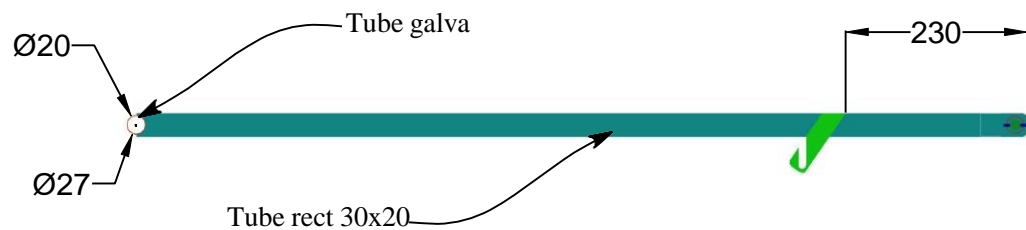
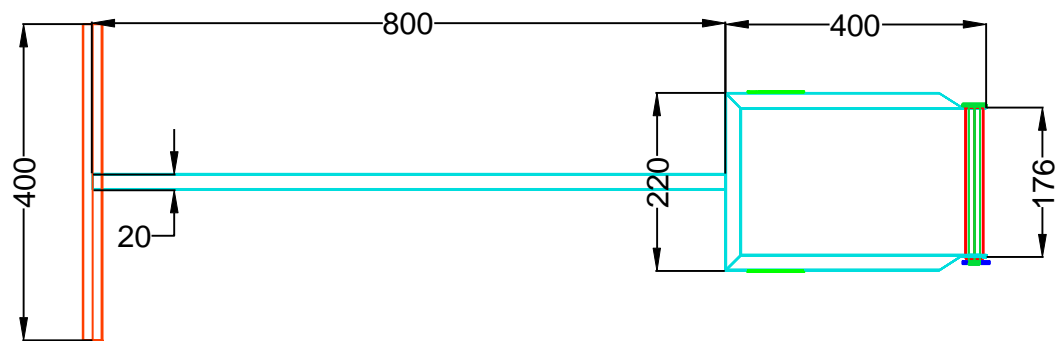

MINISTÈRE DE L'AGRICULTURE ET DE L'ELEVAGE
 Projet d'Amélioration de la Productivité Rizicole, de gestion
 des bassins versants et des périmètres Irrigués

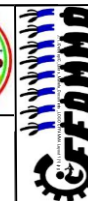

Echelle :

août 2018

Mahefa
 RASOLOHARISON

**SEMOIR POUR RIZ
 PLUVIAL**

Centre de Fabrication, de Formation et d' Application du Machinisme et de la Mécanisation Agricole

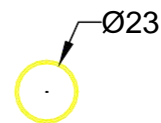
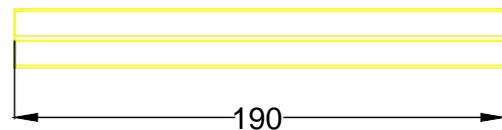
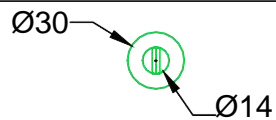
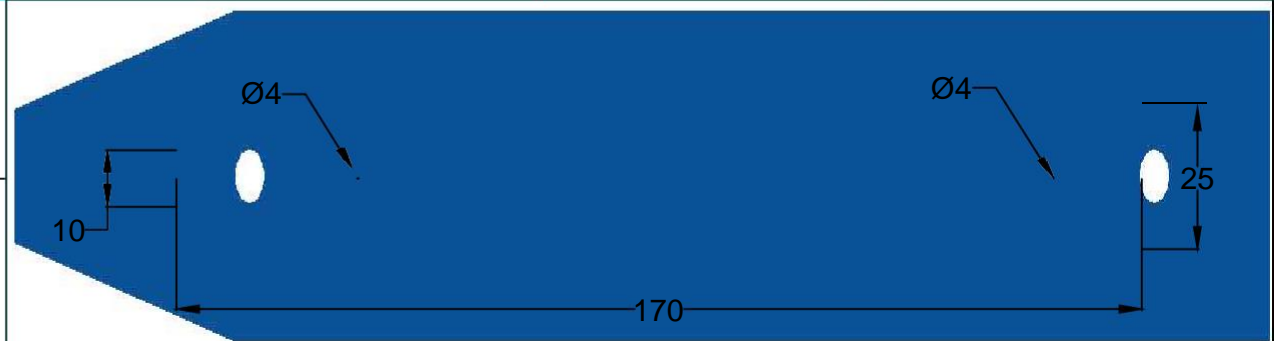
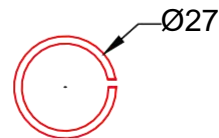
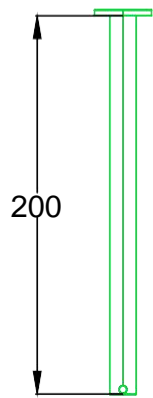
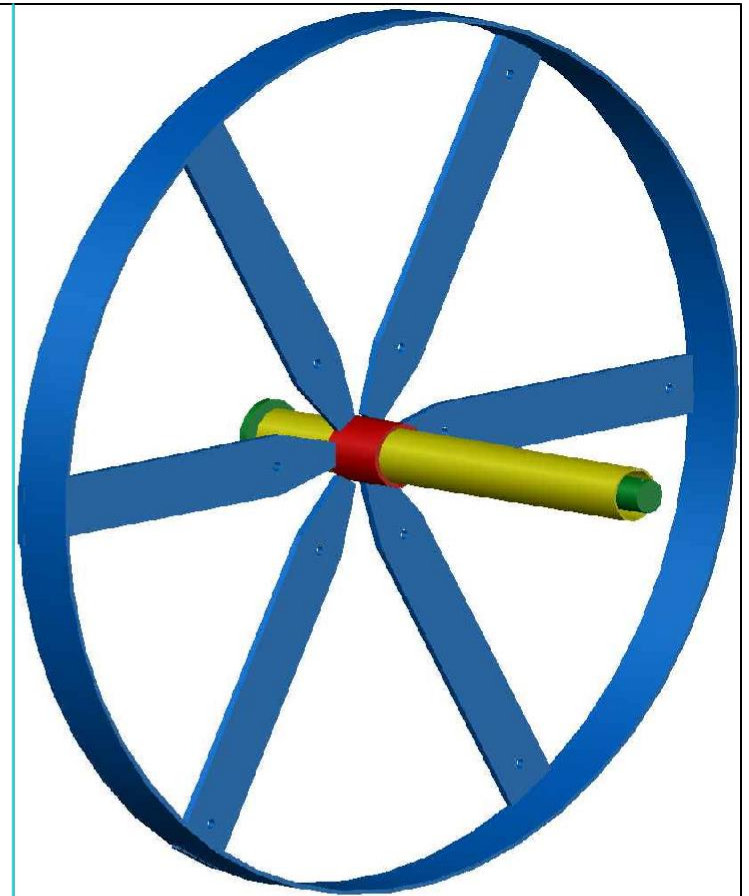
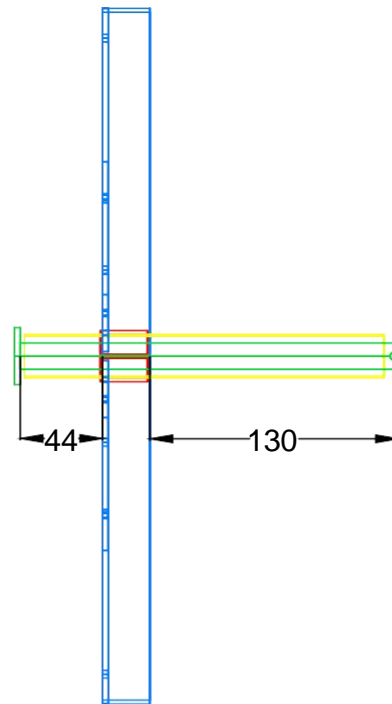
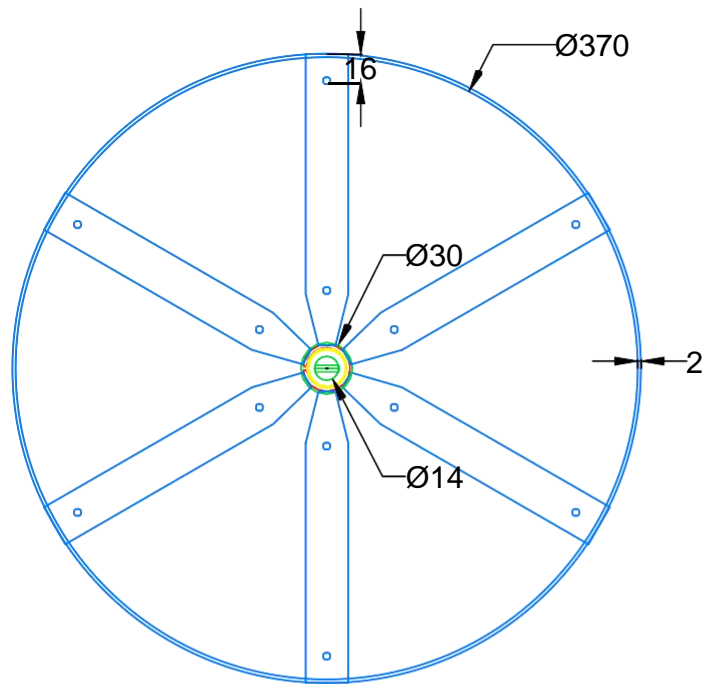

MINISTÈRE DE L'AGRICULTURE ET DE L'ÉLEVAGE
Projet d'Amélioration de la Productivité Rizicole, de gestion
des bassins versants et des périmètres Irrigués



Echelle :

août 2018

Mahefa
RASOLOHARISON

SEMOIR POUR RIZ
PLUVIAL

Centre de Fabrication, de Formation et d' Application du Machinisme et de la Mécanisation Agricole

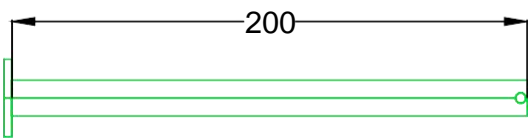
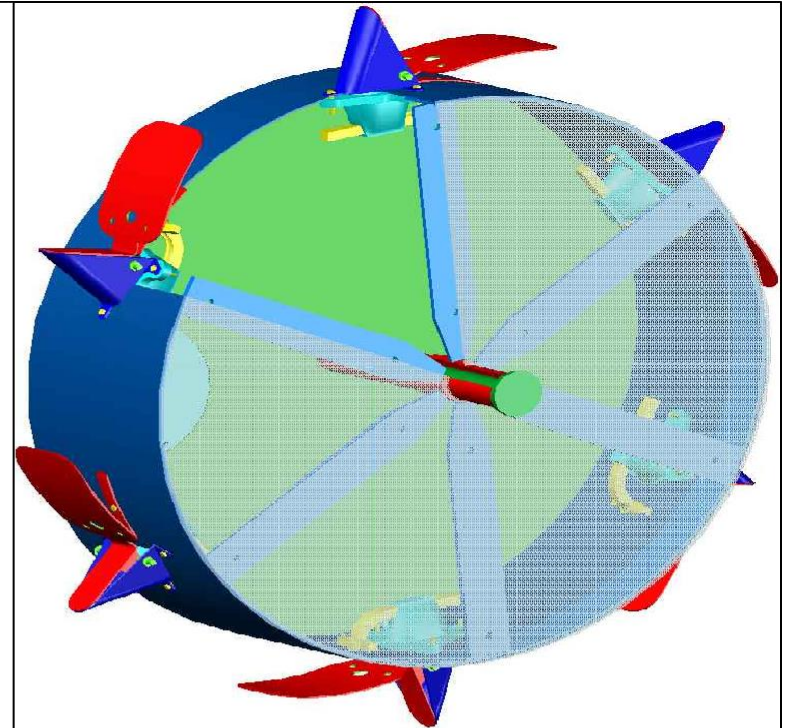
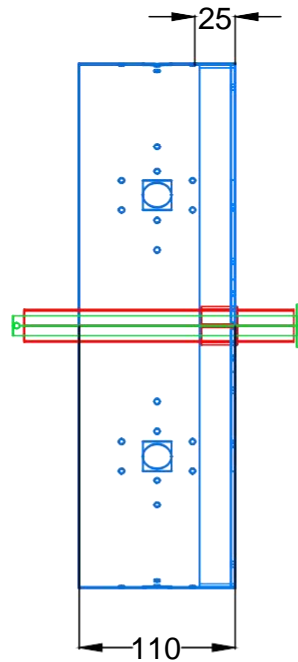
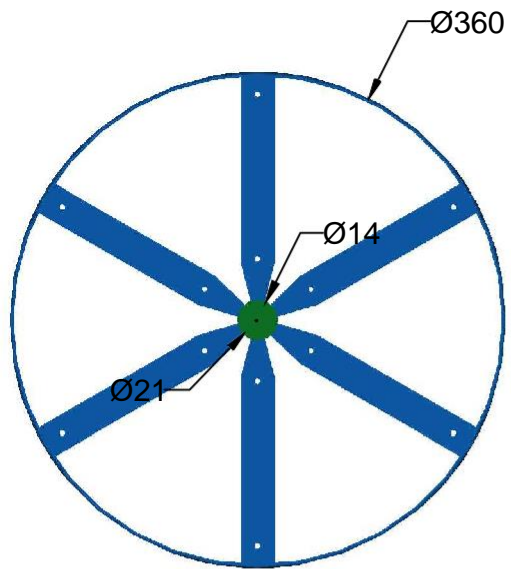

Fer Ø14

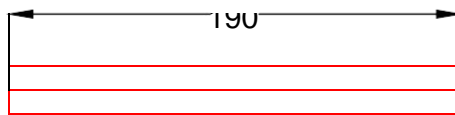

Tube Ø15/21



Fer plat 25x2x170 mm

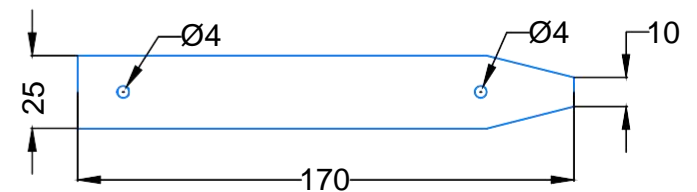

MINISTÈRE DE L'AGRICULTURE ET DE L'ELEVAGE
Projet d'Amélioration de la Productivité Rizicole, de gestion
des bassins versants et des périmètres Irrigués



Echelle :
août 2018
Mahefa
RASOLOHARISON

SEMOIR POUR RIZ PLUVIAL

Centre de Fabrication, de Formation et d' Application du Machinisme et de la Mécanisation Agricole

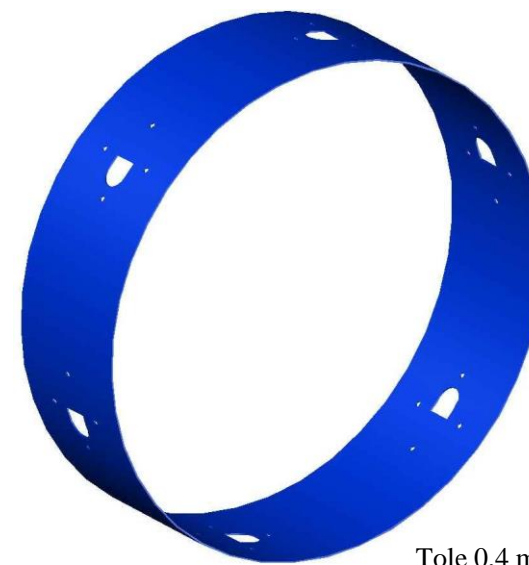
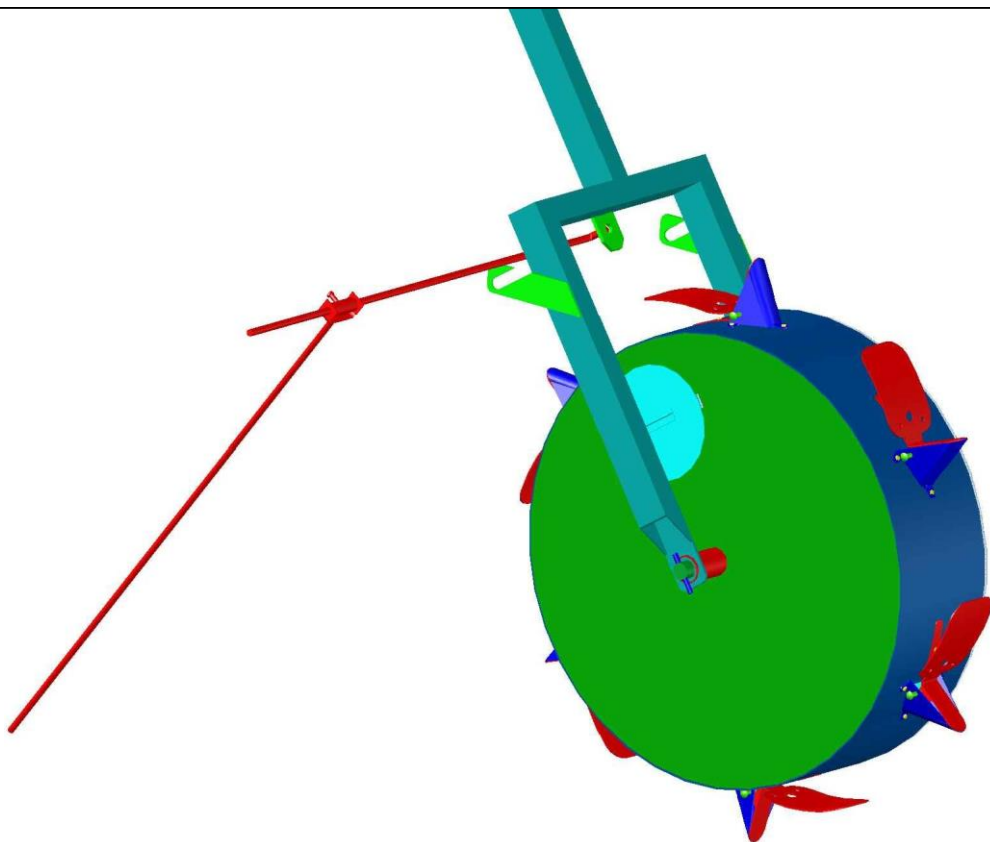
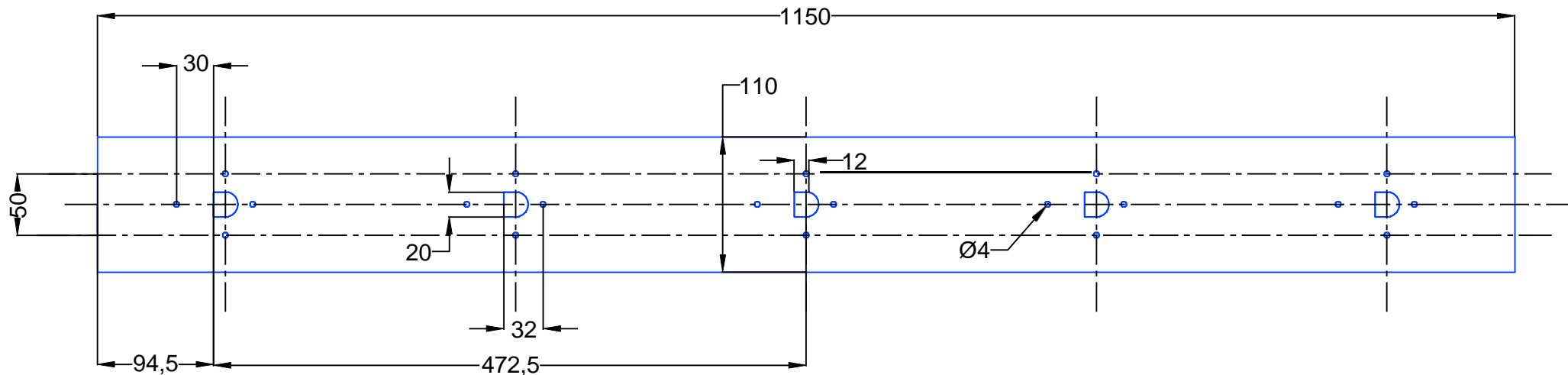

MINISTRE DE L'AGRICULTURE ET DE L'ELEVAGE
 Projet d'Amélioration de la Productivité Rizicole, de gestion
 des bassins versants et des périmètres Irrigués



Echelle :
 août 2018
 Mahefa
RASOLOHARISON
 Centre de Fabrication, de Formation et d' Application du Machinisme et de la Mécanisation Agricole

**SEMOIR POUR RIZ
 PLUVIAL**

Echelle 1:1

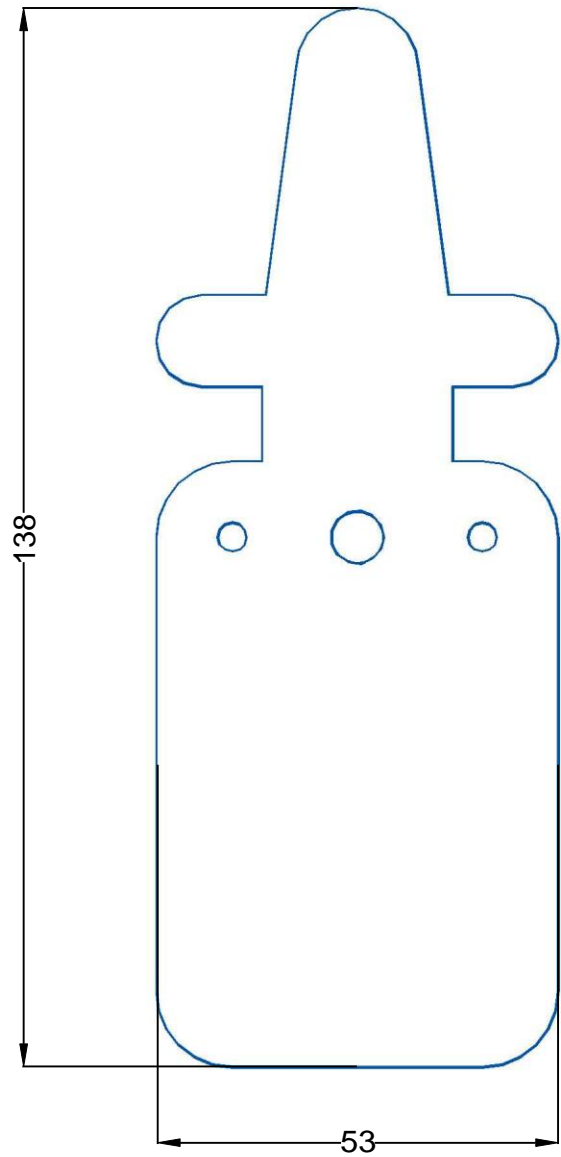



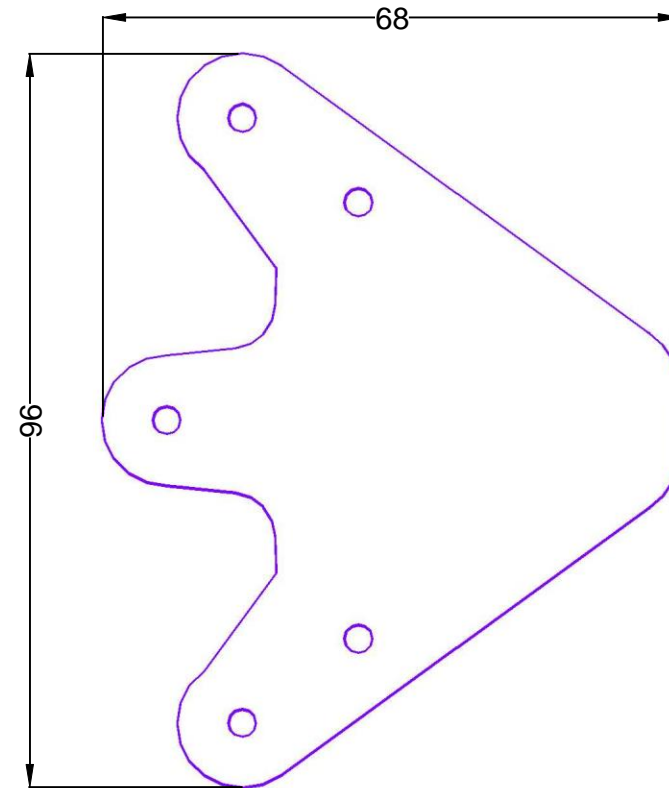

TPN 12/10 1.2mm

Echelle 1:1



TPN 12/10 1.2mm

	MINISTERE DE L'AGRICULTURE ET DE L'ELEVAGE Projet d'Amélioration de la Productivité Rizicole, de gestion des bassins versants et des périmètres Irrigués			
	Echelle :			
	août 2018	SEMOIR POUR RIZ PLUVIAL		
	Mahefa RASOLOHARISON			
	Centre de Fabrication, de Formation et d' Application du Machinisme et de la Mécanisation Agricole			

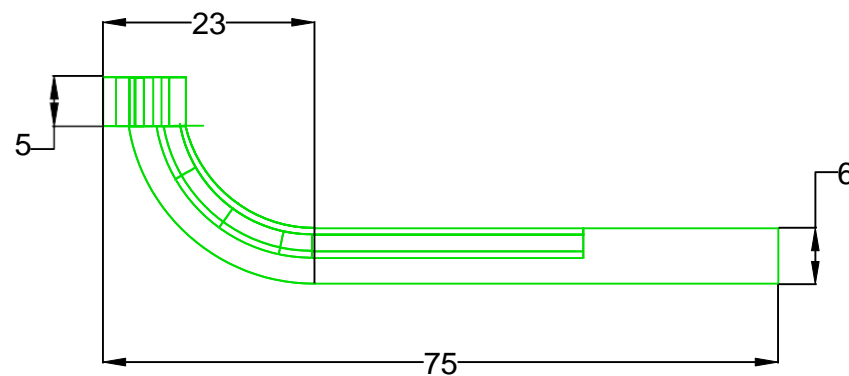
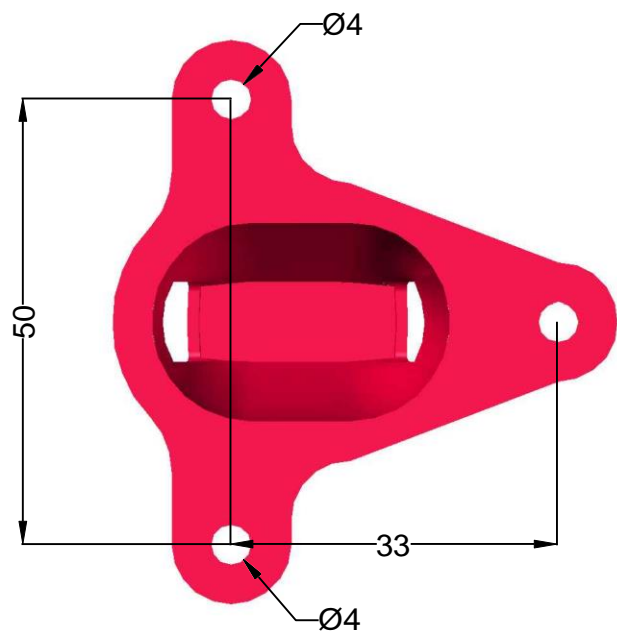
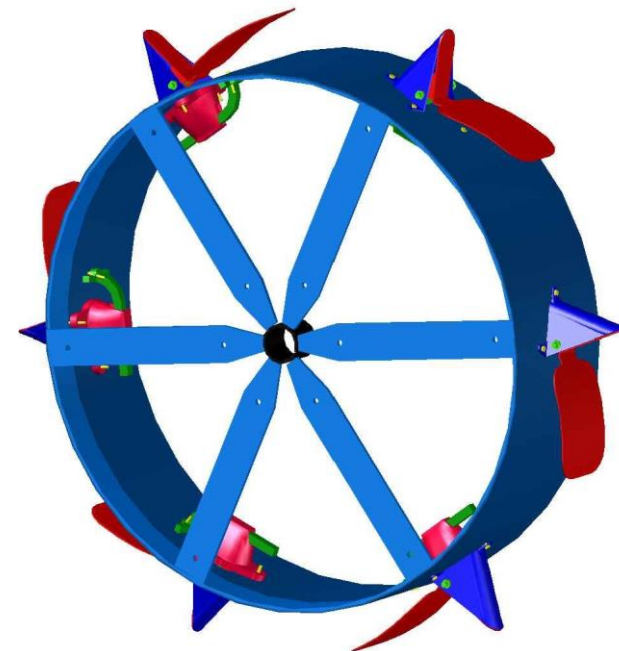
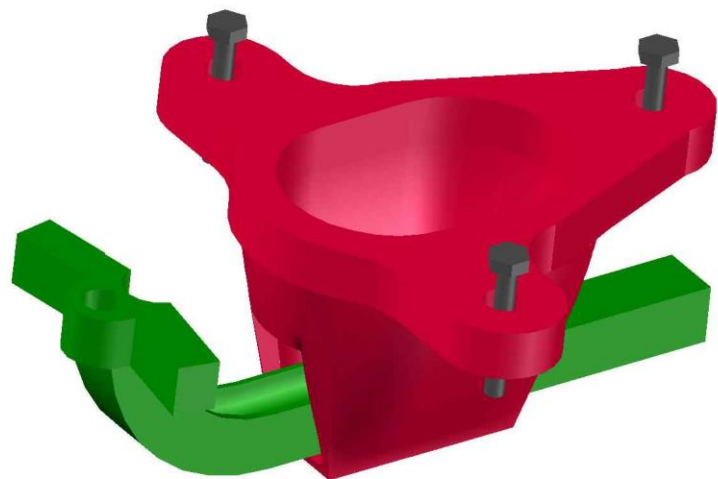

MINISTÈRE DE L'AGRICULTURE ET DE L'ÉLEVAGE
 Projet d'Amélioration de la Productivité Rizicole, de gestion
 des bassins versants et des périmètres Irrigués



Echelle :
 août 2018
 Mahefa
 RASOLOHARISON



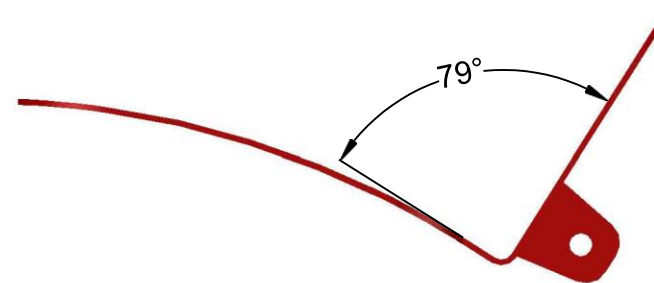
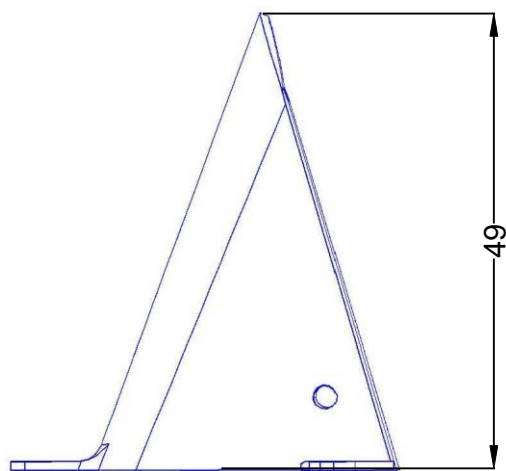
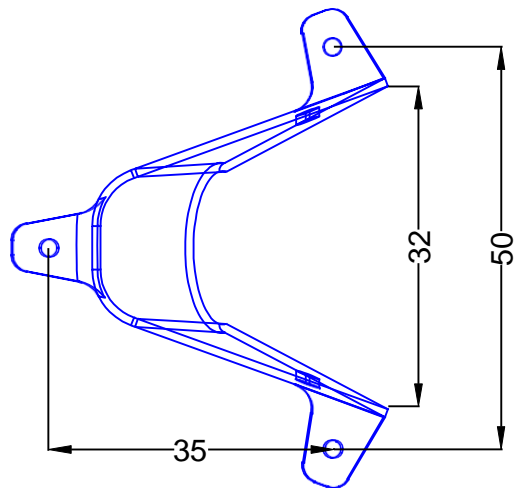

**SEMOIR POUR RIZ
 PLUVIAL**

Centre de Fabrication, de Formation et d' Application du Machinisme et de la Mécanisation Agricole



TPN 12/10 1.2mm

TPN 12/10 1.2mm

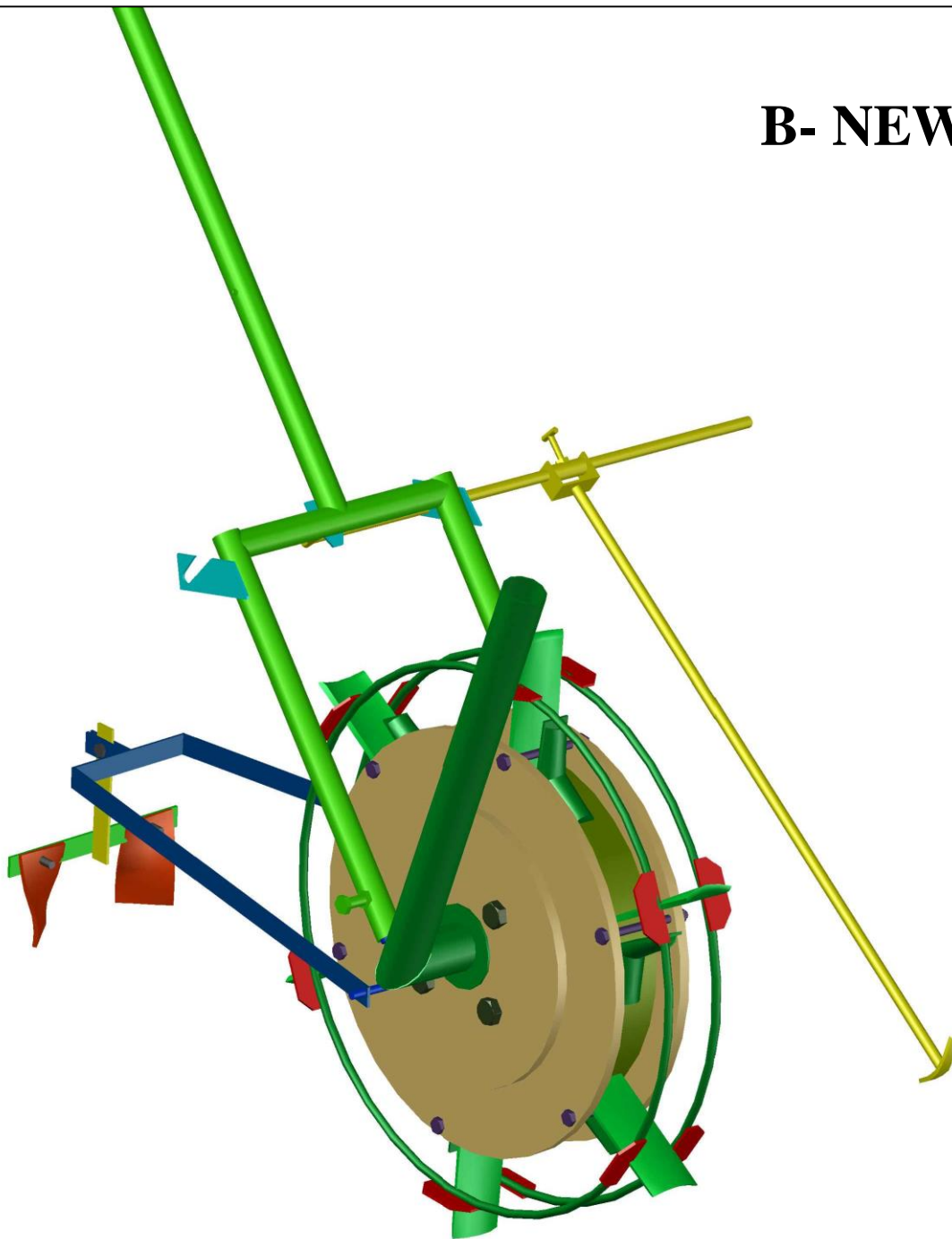

	MINISTÈRE DE L'AGRICULTURE ET DE L'ÉLEVAGE Projet d'Amélioration de la Productivité Rizicole, de gestion des bassins versants et des périmètres Irrigués			
	Echelle : août 2018 Mahefa RASOLOHARISON			
	Centre de Fabrication, de Formation et d' Application du Machinisme et de la Mécanisation Agricole			

B- NEW SEEDER

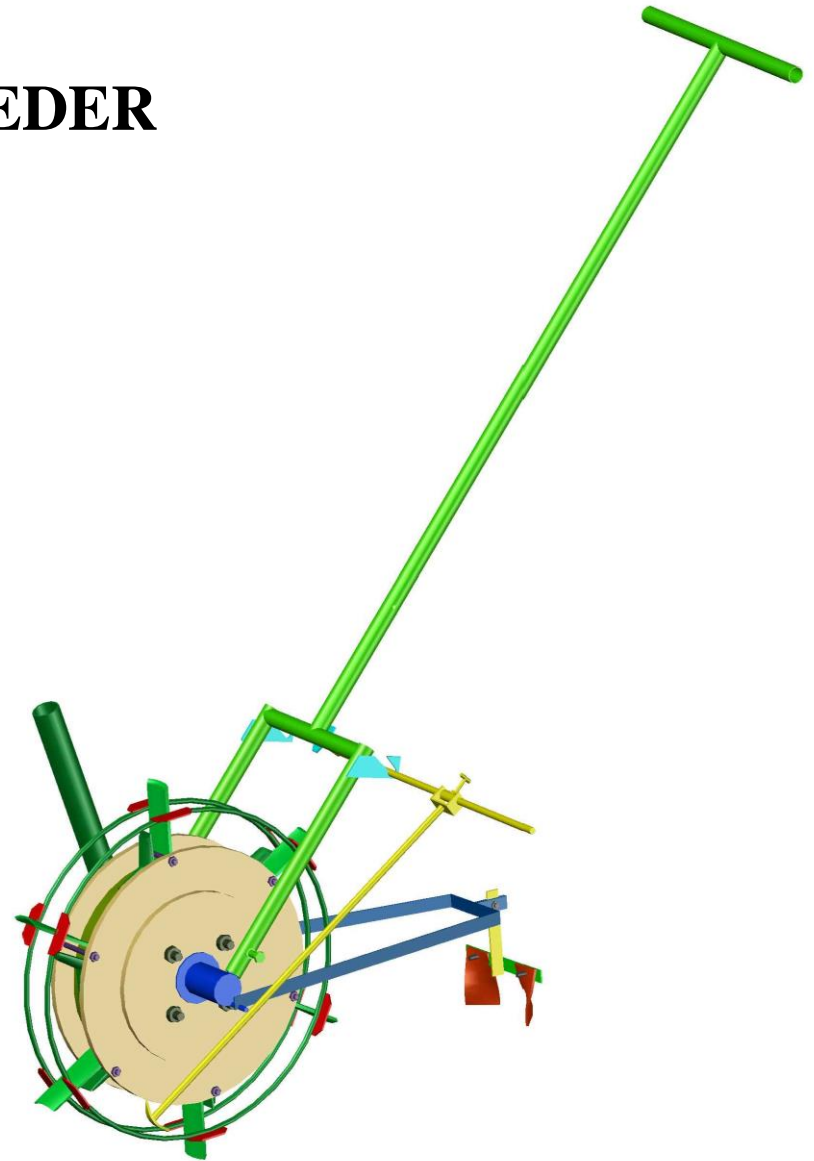

NEW SEEDER

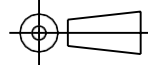

					
				NEW SEEDER	
	Drawn	Mahefa Rasoloharison	04/05/20	Material	Weight (kg)
	Mail	maahefarivo@gmail.com			
Scale :		Name	Date	DRAWING N° :	

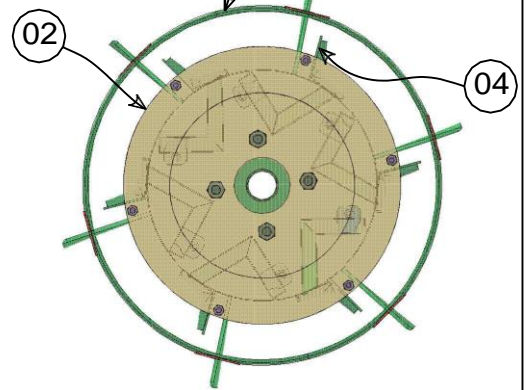
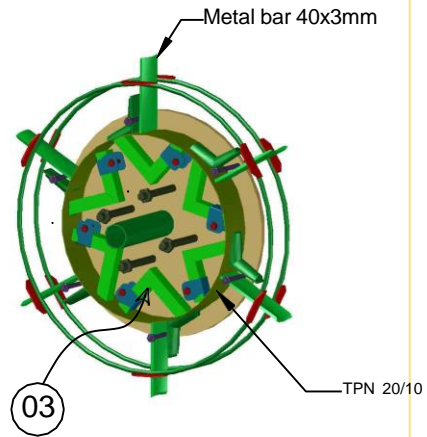
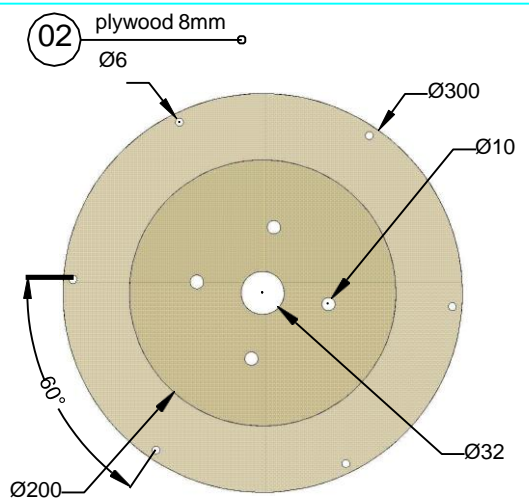
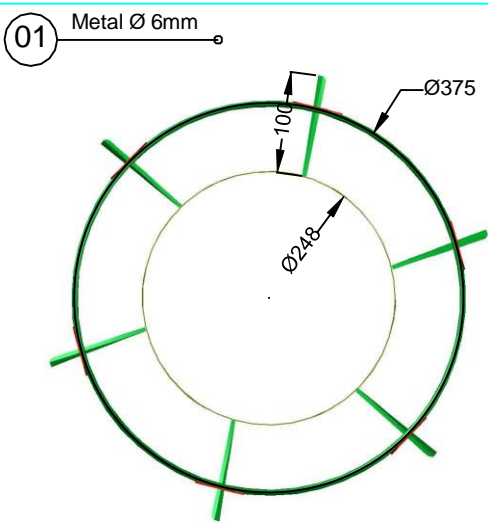
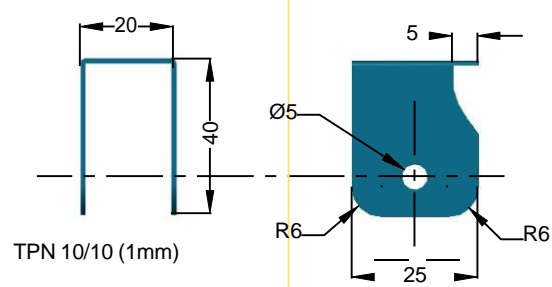
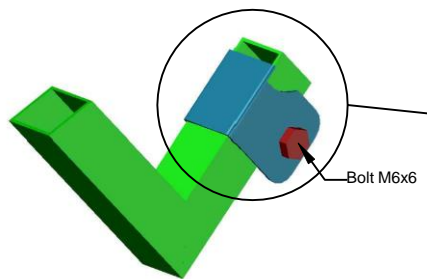
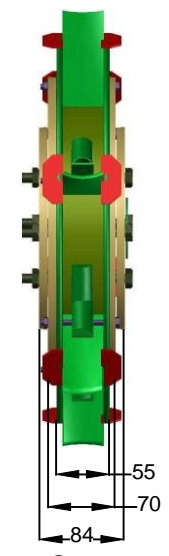
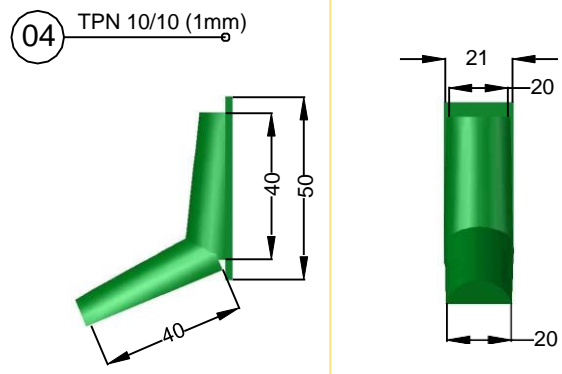
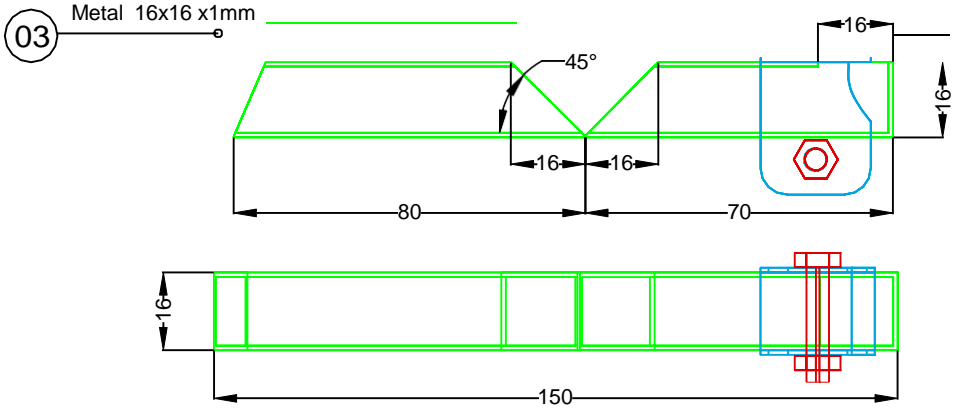

NEW SEEDER

Scale :	Drawn	Mahefa Rasoloharison	04/05/20	Material	Weight (kg)
	Mail	maahefarivo@gmail.com			
	Name		Date	DRAWING N° : 001	

02

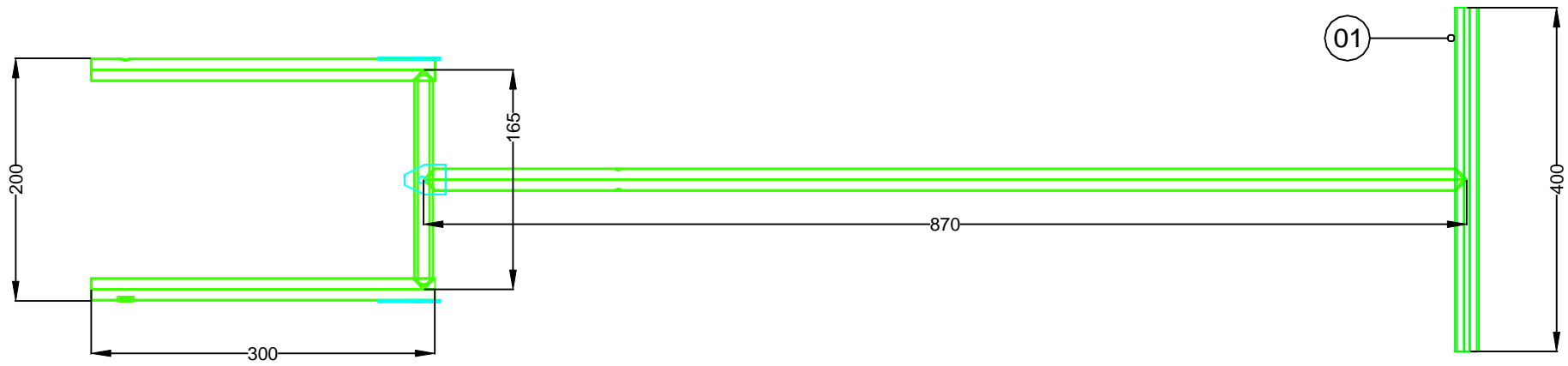

01 Tube 20/27

02 Tube 15/21

03

04

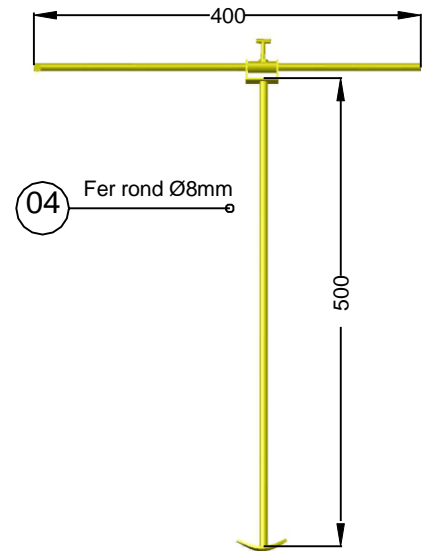
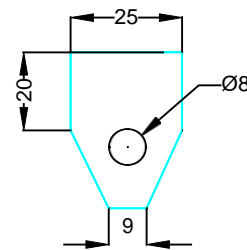
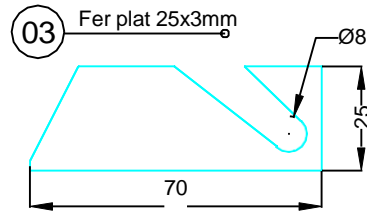

04 Fer rond Ø8mm

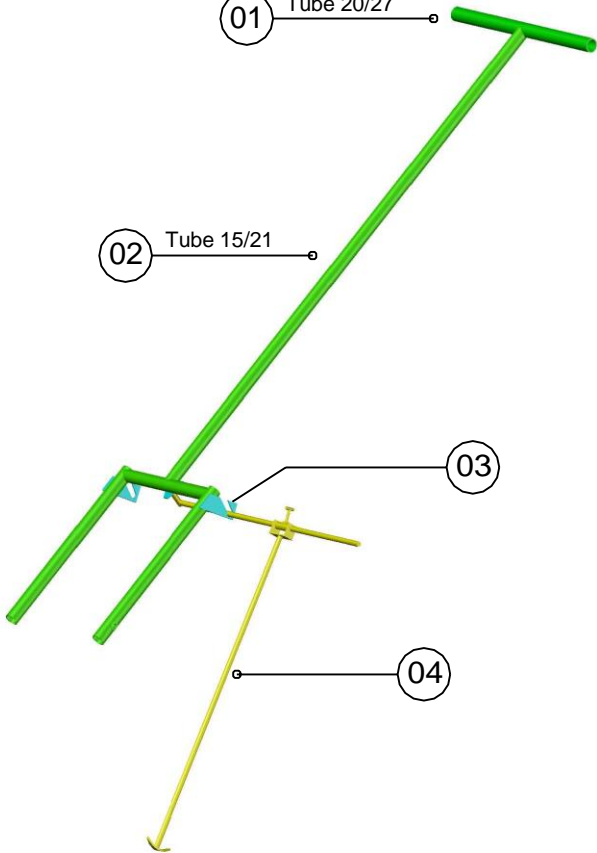

NEW SEEDER

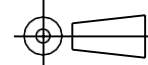

Scale :

Drawn	Mahefa Rasoloharison	
Mail	maahfarivo@gmail.com	04/05/20
	Name	Date

Material	Weight (kg)
DRAWING N° : 002	

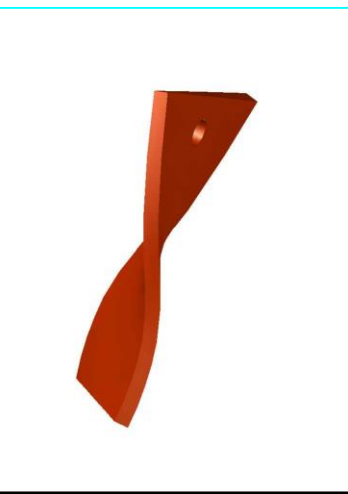
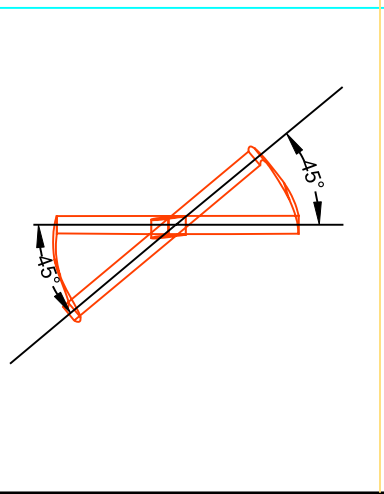
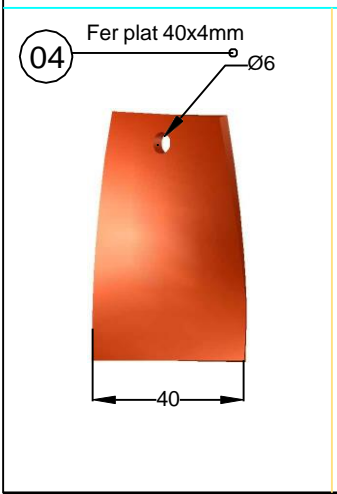
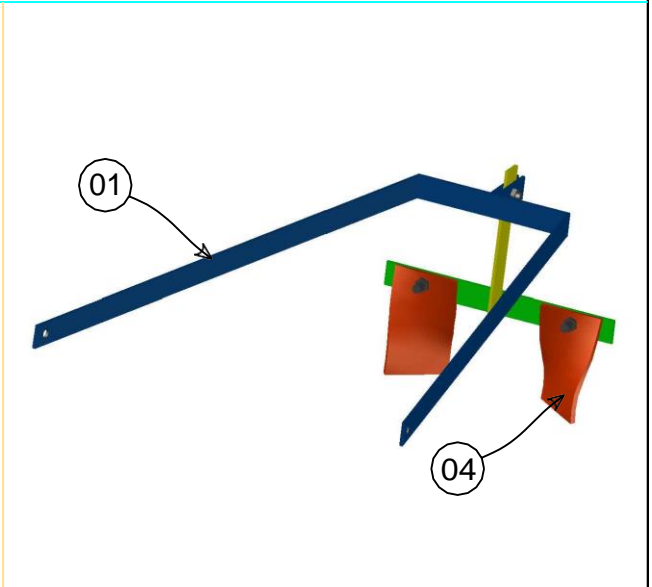
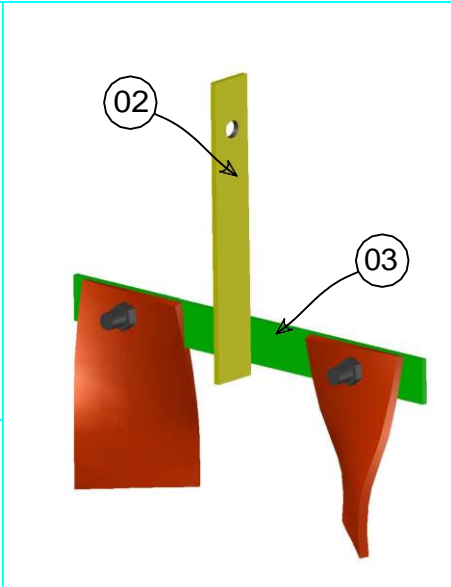
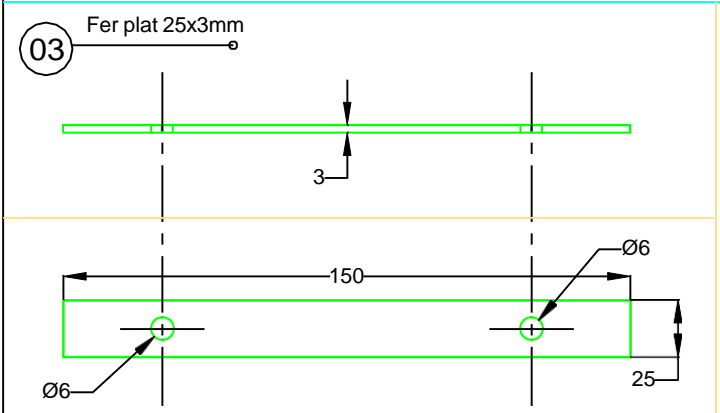
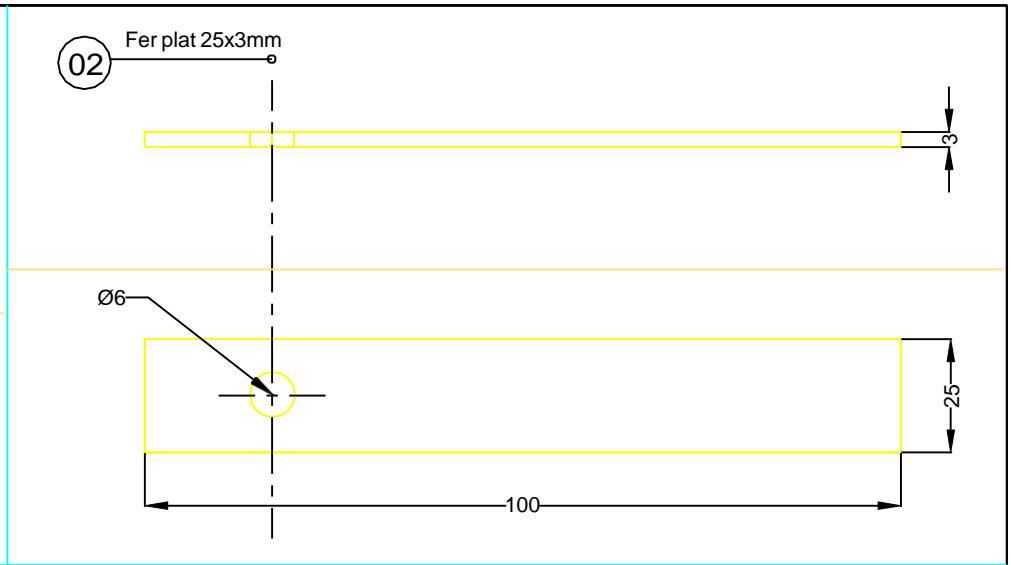
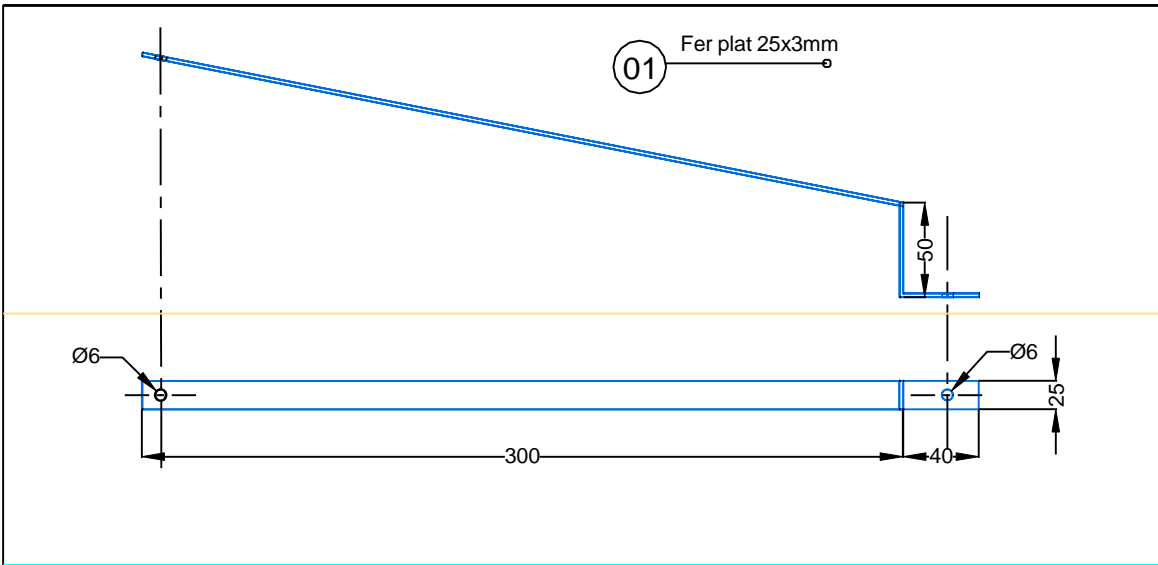

		NEW SEEDER		 AfricaRice		
						Drawn
 Scale :		Mail	maahefarivo@gmail.com	04/05/20	Material	Weight (kg)
		Name		Date	DRAWING N° : 003	

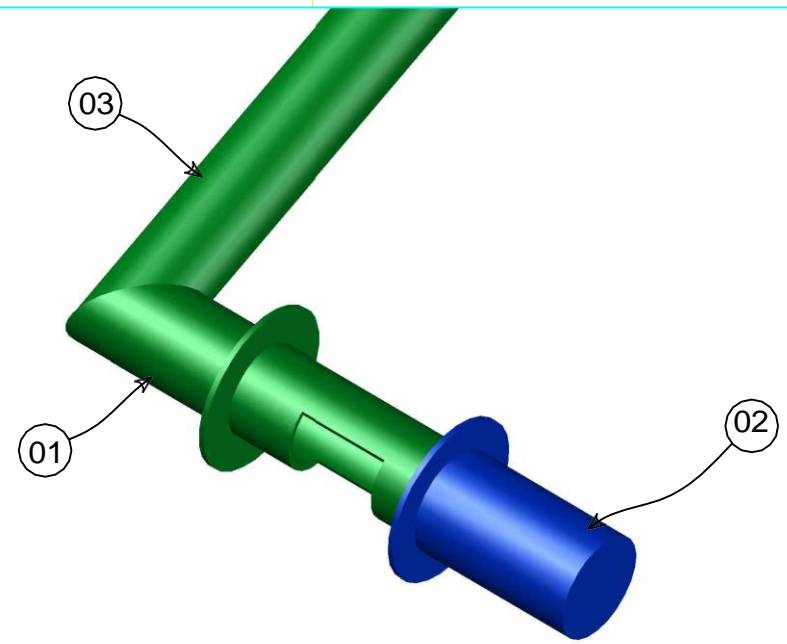
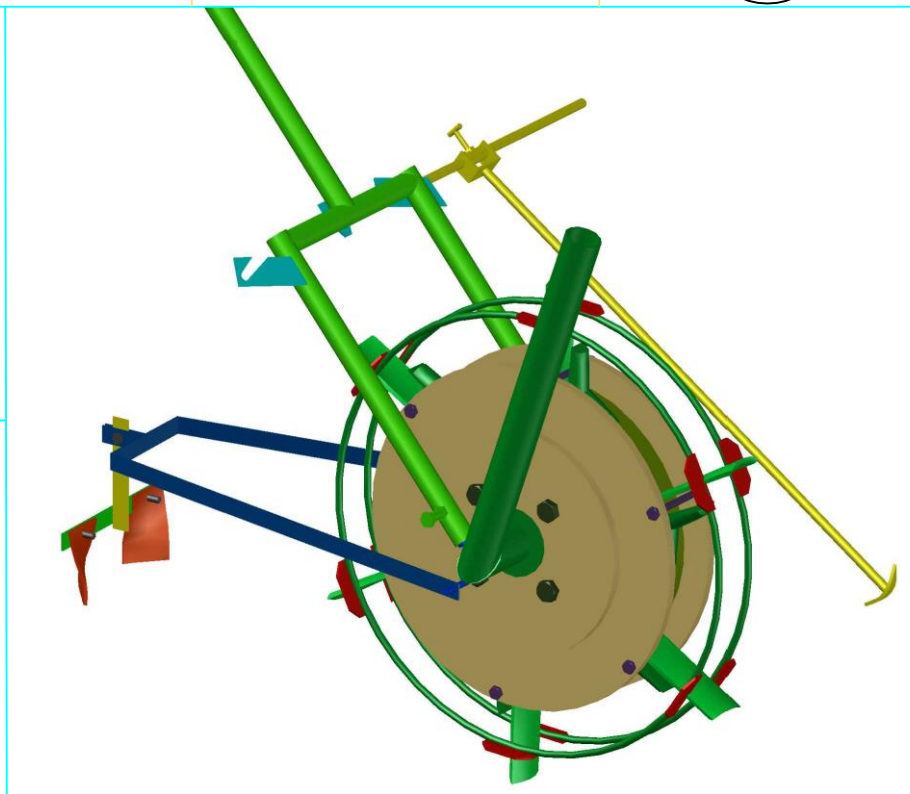
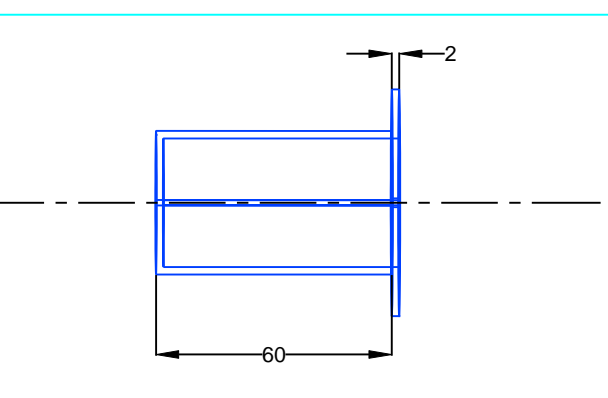
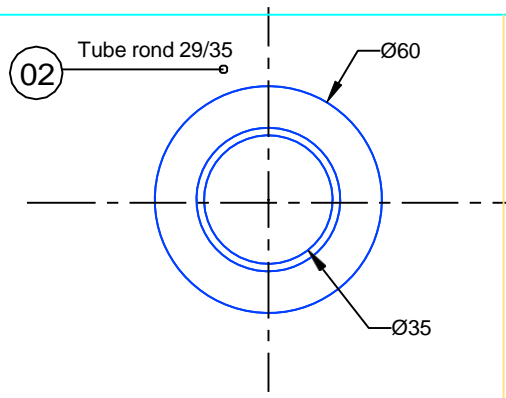
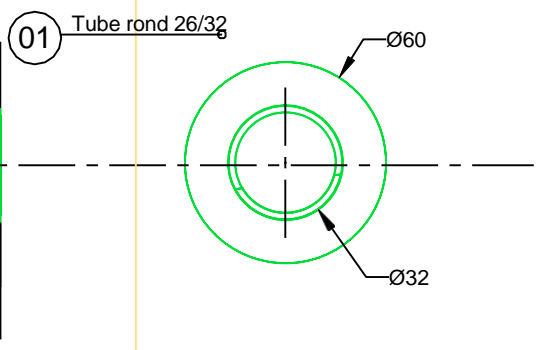
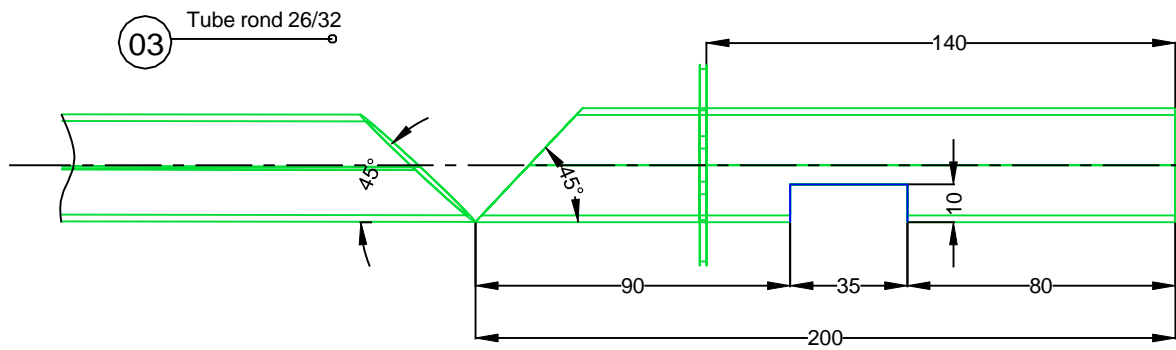

	NEW SEEDER			
	Drawn	Mahefa Rasoloharison		
	Mail	maahefarivo@gmail.com	04/05/20	Material
Scale :				Weight (kg)
		Name	Date	DRAWING N° : 004

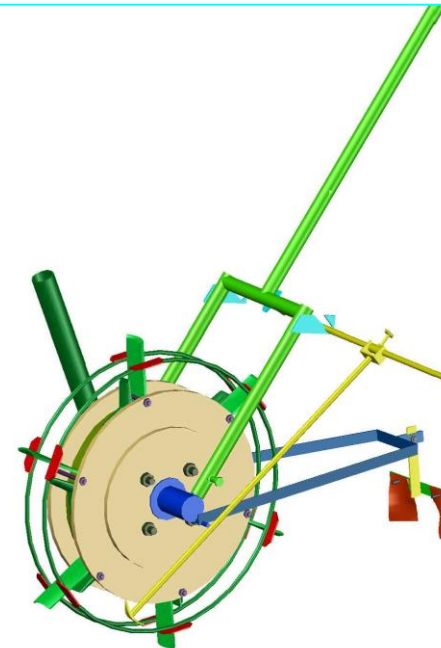
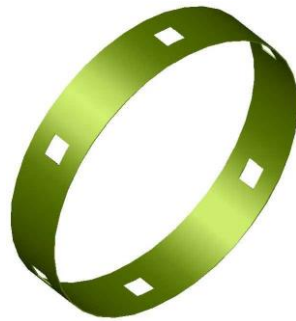
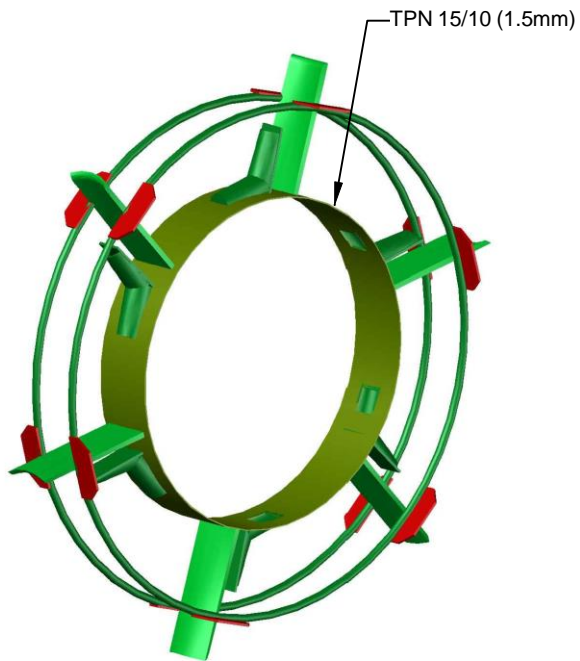
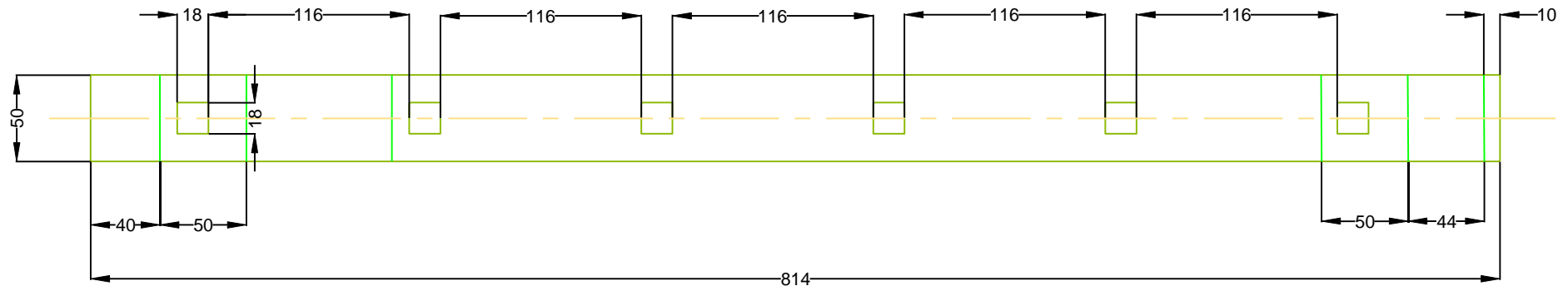

NEW SEEDER

	Drawn	Mahefa Rasoloharison		Material	Weight (kg)
	Mail	maahefarivo@gmail.com	04/05/20		
Scale :		Name	Date	DRAWING N° : 005	

C- FERTISEEDER 1

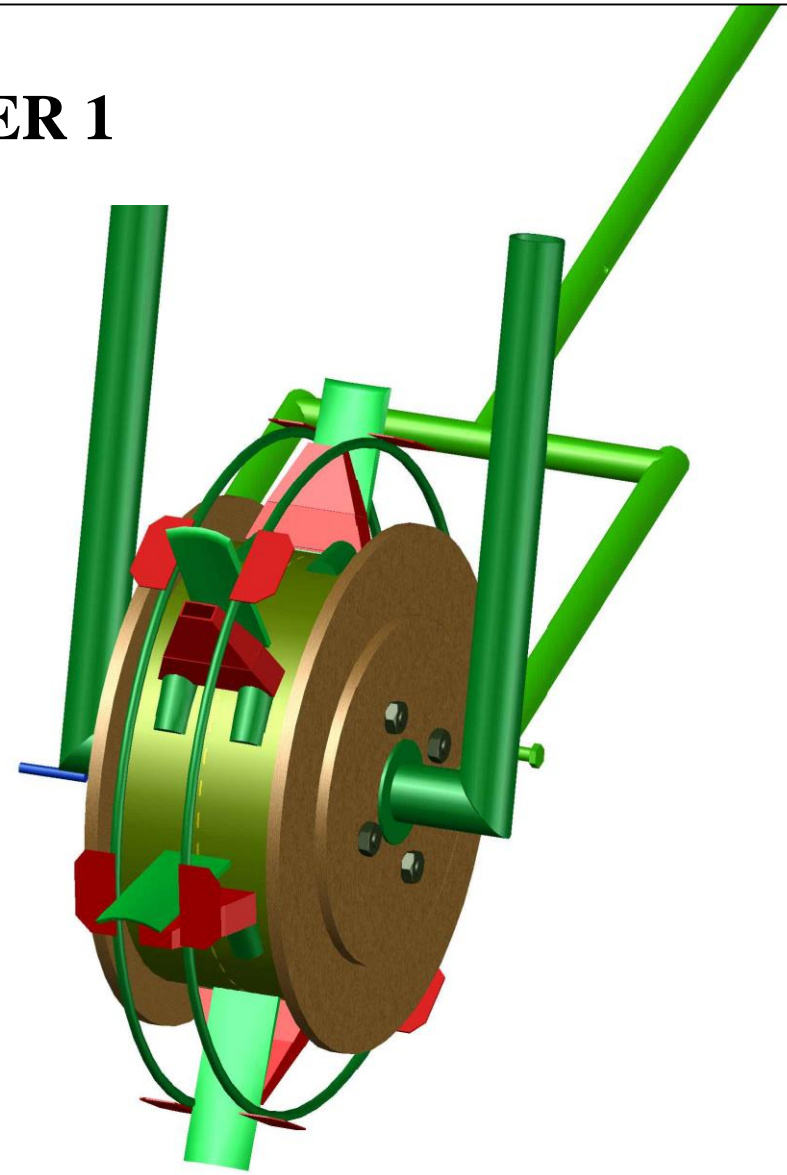
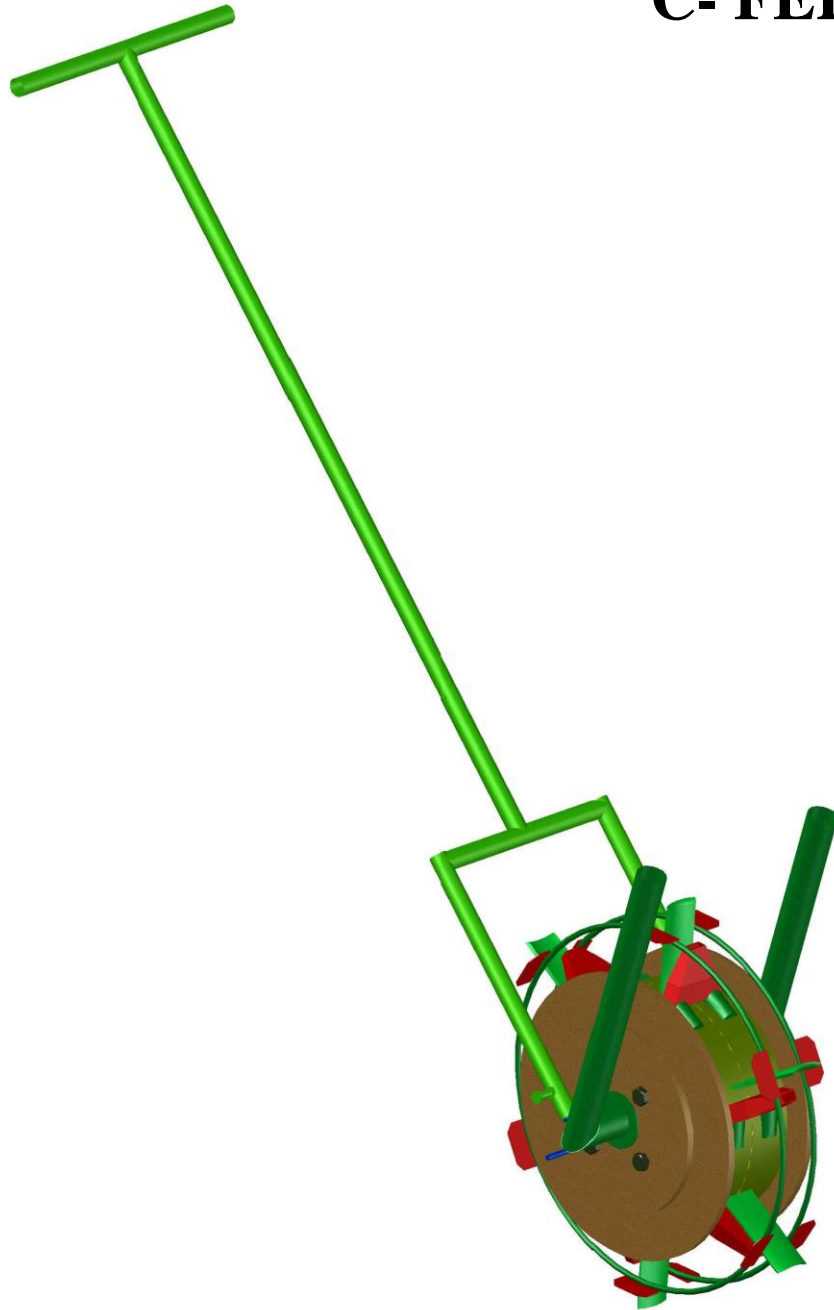

FERTISEEDER

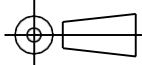
		FERTISEEDER		 AfricaRice	
	Drawn	Mahefa Rasoloharison		Material	Weight (kg)
	Mail	maahfarivo@gmail.com	04/05/20		
Scale :		Name	Date	DRAWING N° : 001	

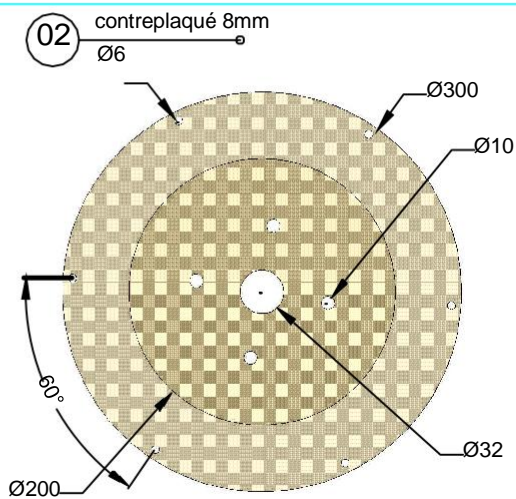
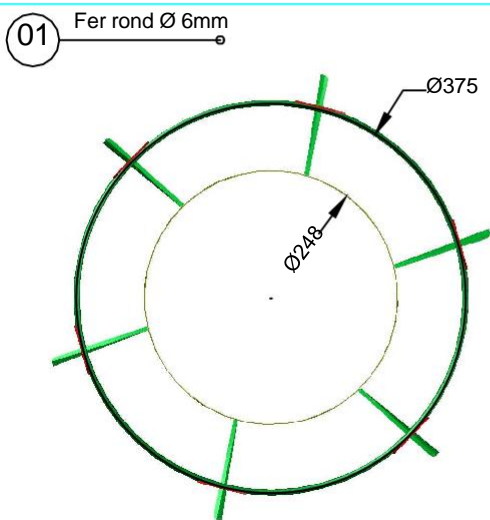
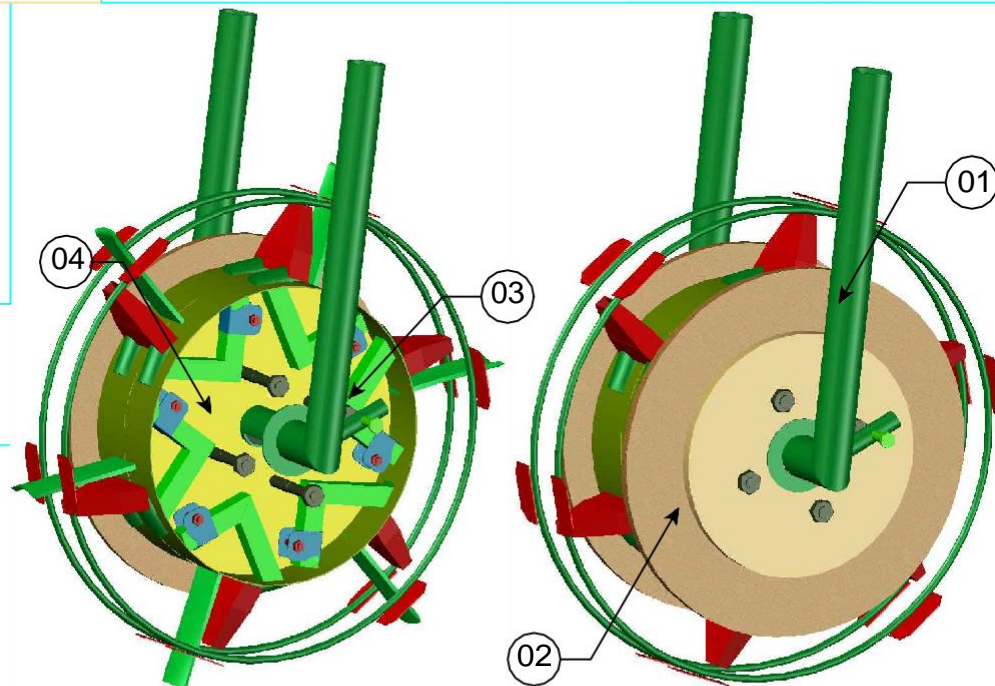
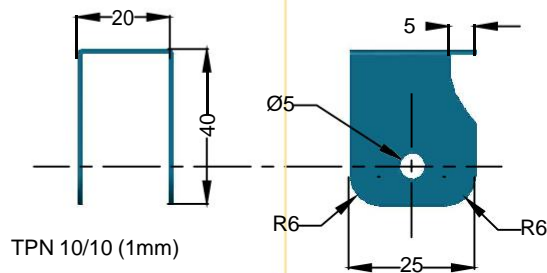
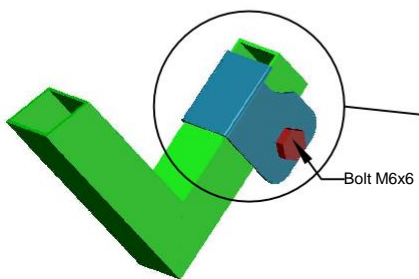
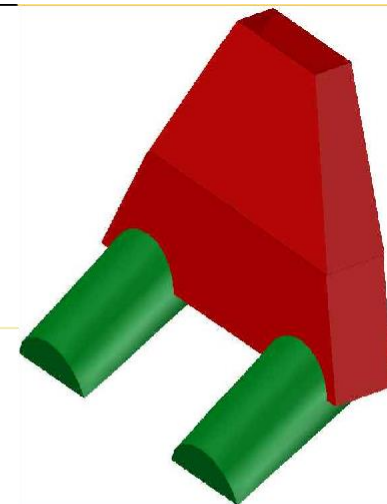
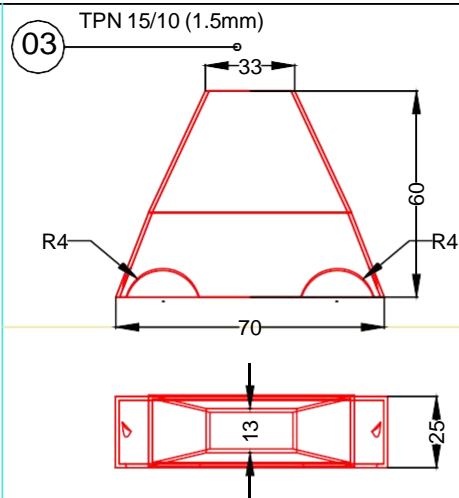
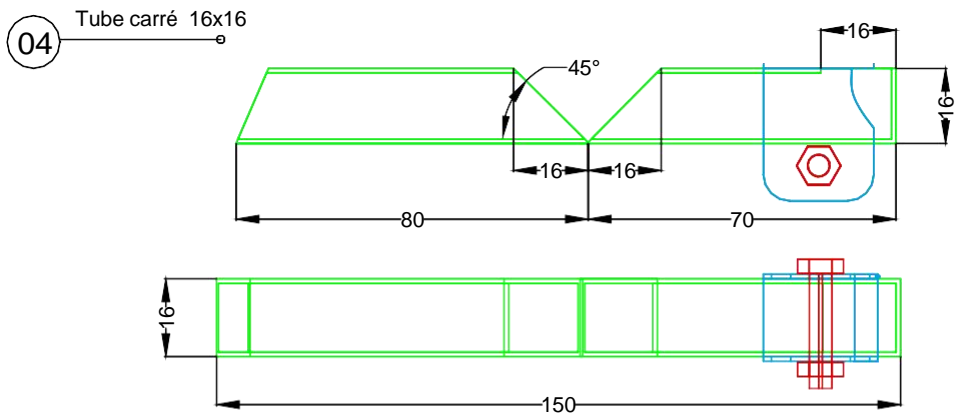

	FERTISEEDER				
	Rolling injection seeder				
	Drawn	Mahefa Rasoloharison	04/05/20	Material	Weight (kg)
	Mail	maahefarivo@gmail.com			
Scale :		Name	Date	DRAWING N° : 002	

03 Tube rond 26/32

01 Tube rond 26/32

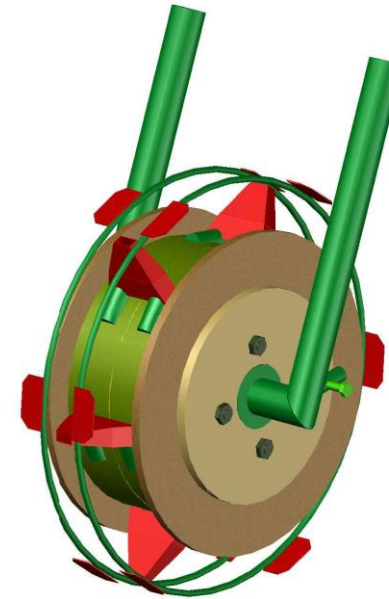
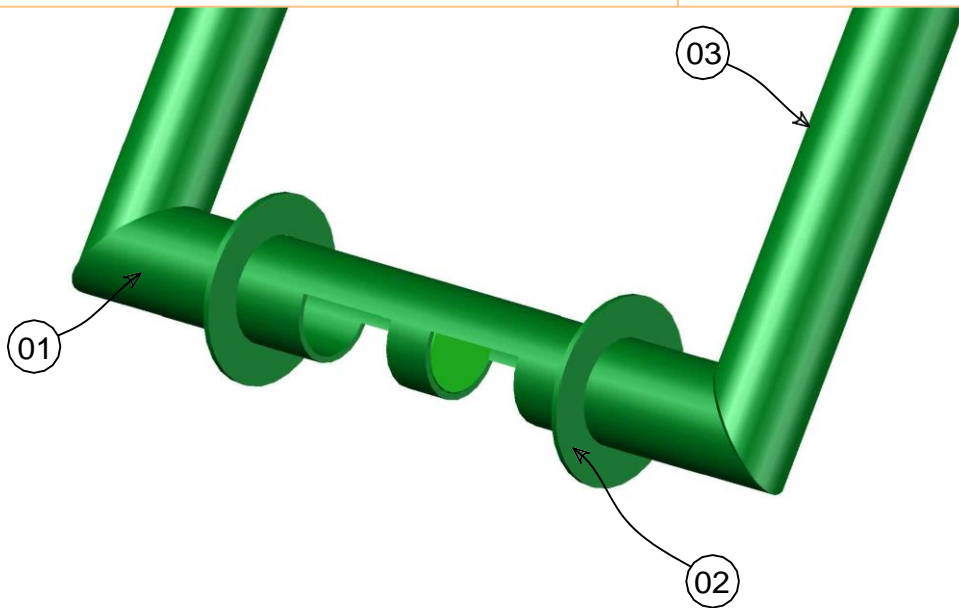
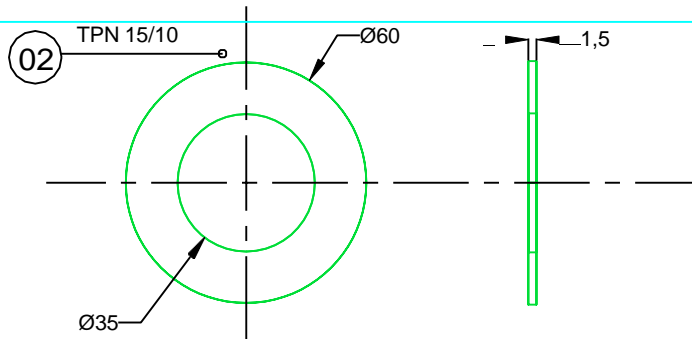
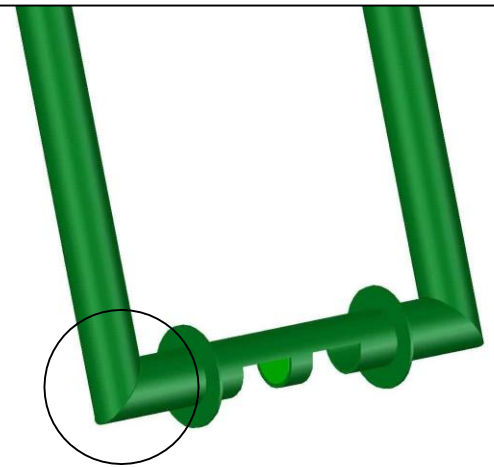
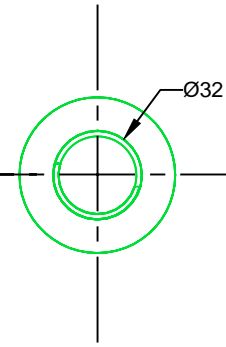
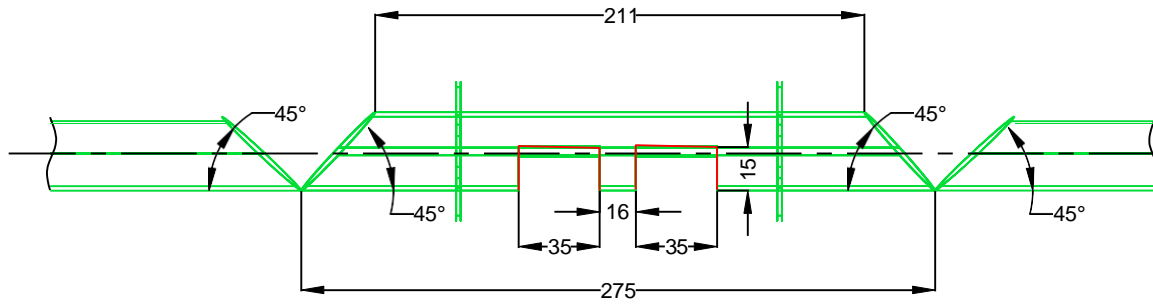

FERTISEEDER

Rolling injection seeder

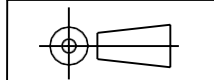

Drawn

Mail

Mahefa Rasoloharison

maahefarivo@gmail.com

04/05/20

Material

Weight

(kg)

Scale :

Name



Date

DRAWING N° : 003

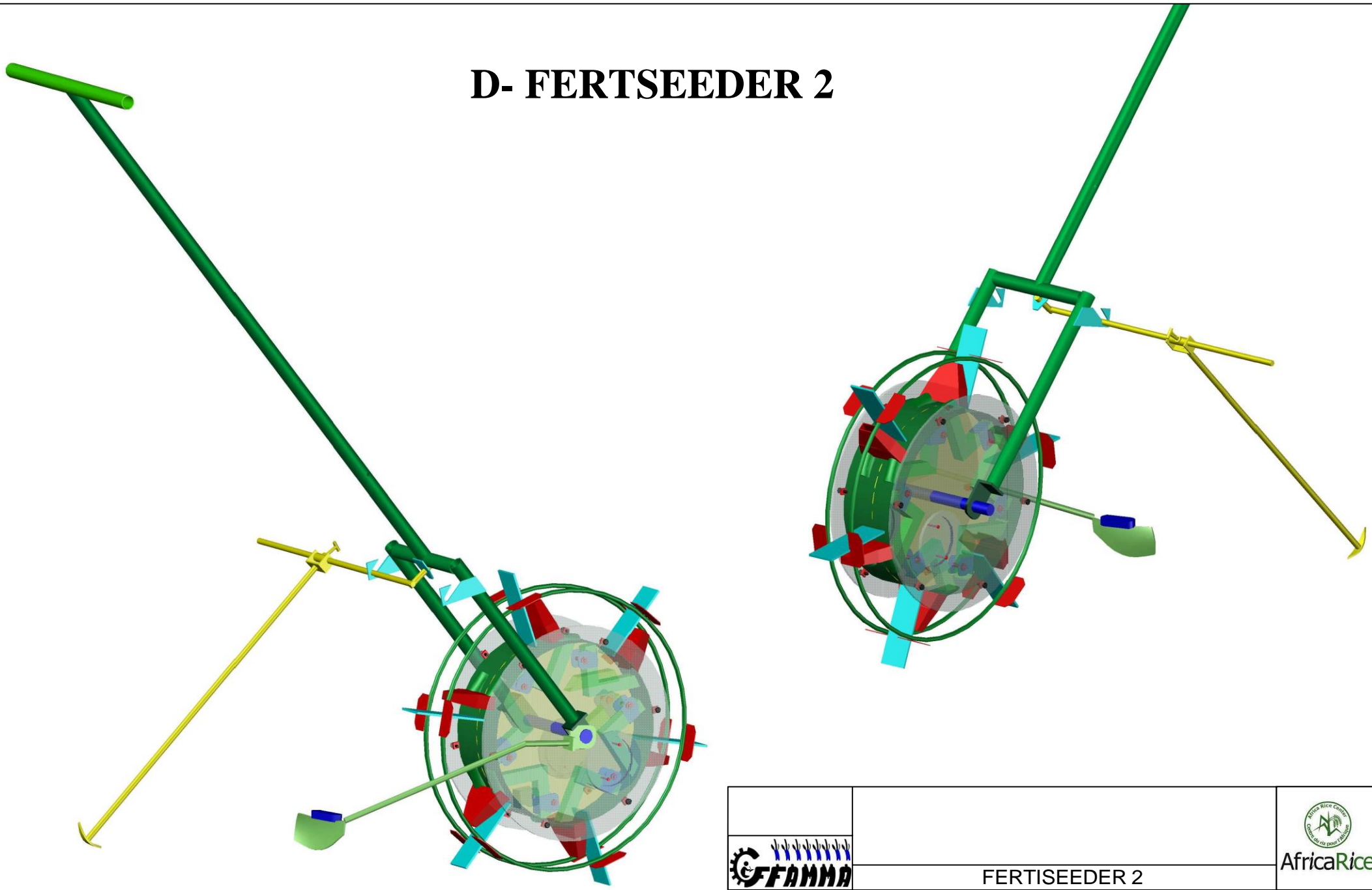
D- FERTSEEDER 2

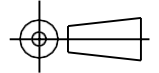

FERTISEEDER 2

		FERTISEEDER 2		 AfricaRice	
 Scale :	Drawn	Mahefa Rasoloharison		Material	Weight (kg)
	Mail	maahefarivo@gmail.com	04/05/20		
		Name	Date	DRAWING N° : 001	

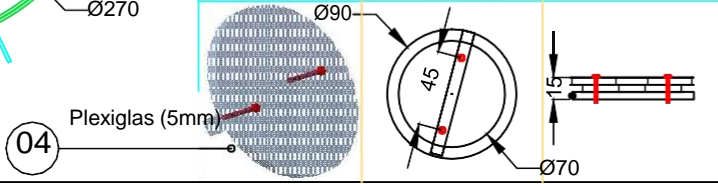
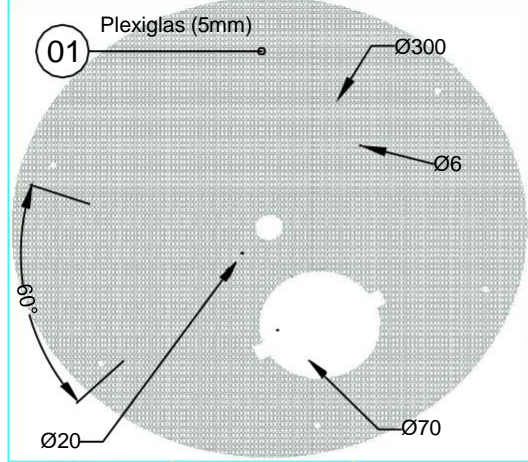
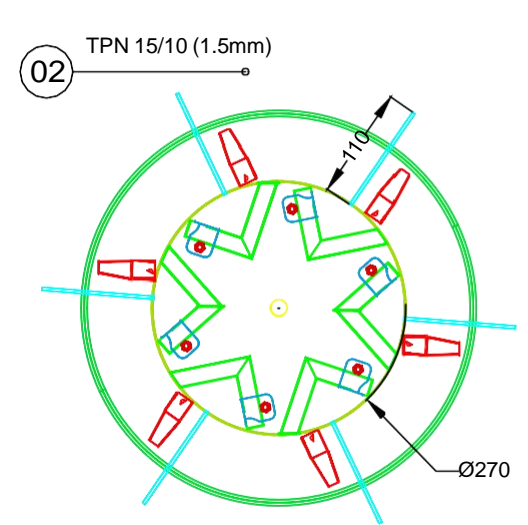
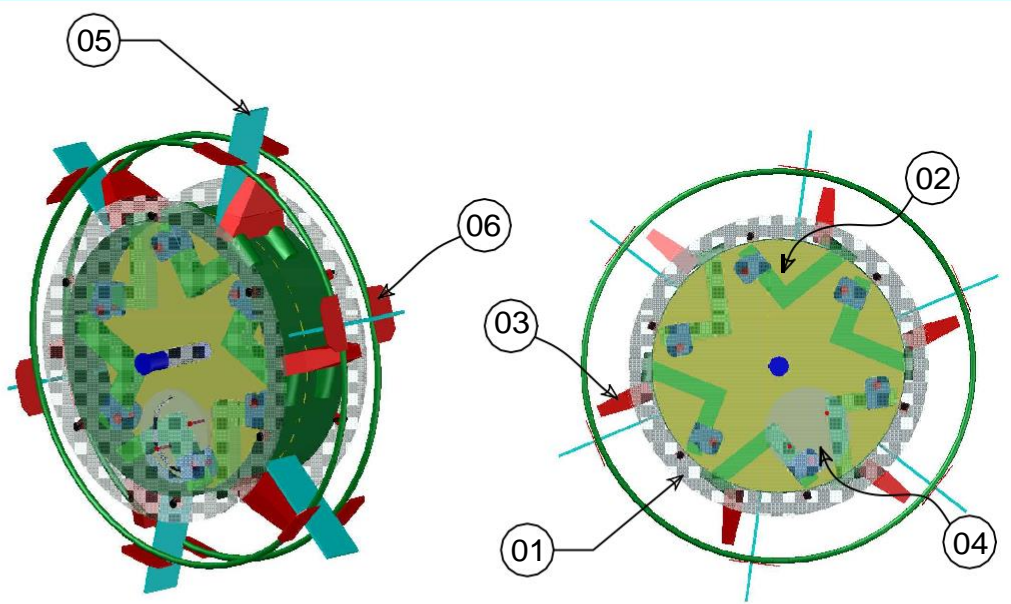
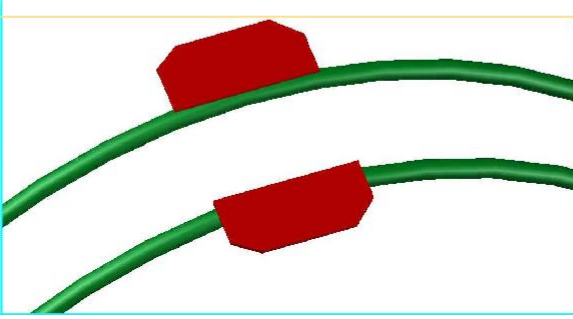
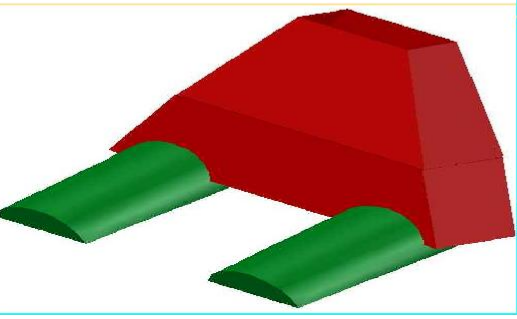
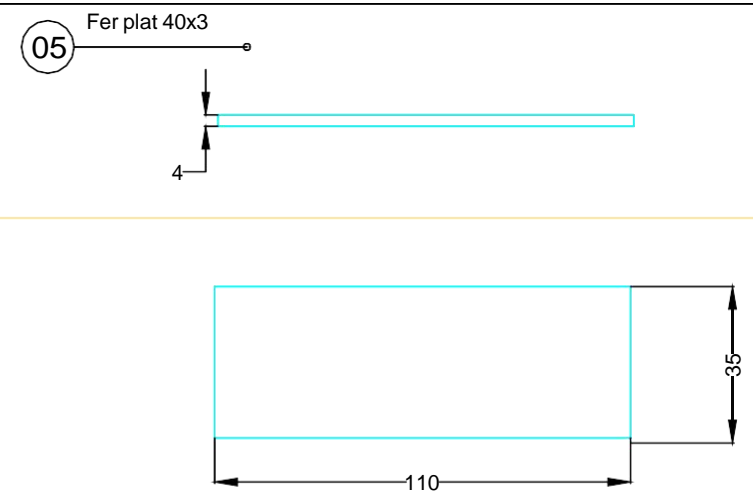
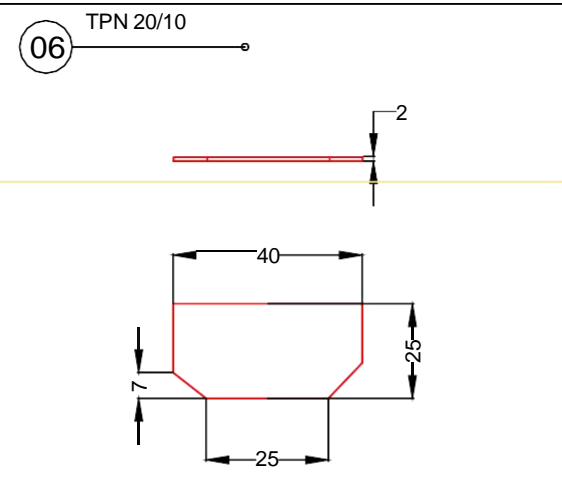
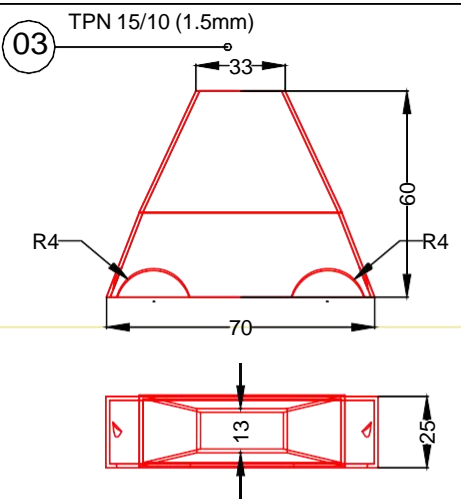

	FERTISEEDER 2				
	Drawn Mail	Mahefa Rasoloharison maahefarivo@gmail.com	04/05/20	Rolling injection seeder	
Scale :	Name	Date	Material	Weight (kg)	DRAWING N° : 002

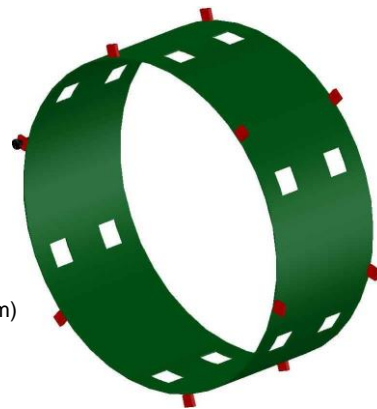
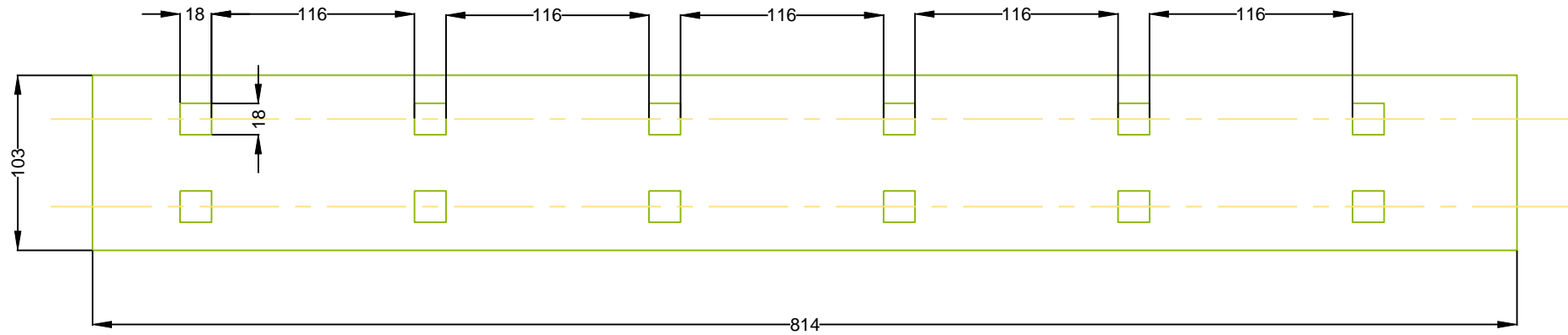

TPN 15/10 (1.5mm)

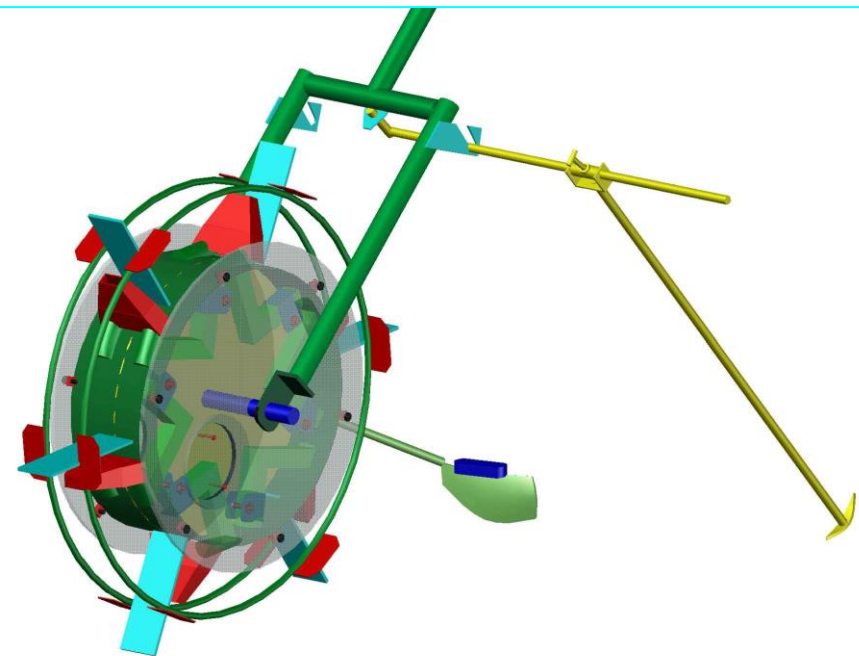
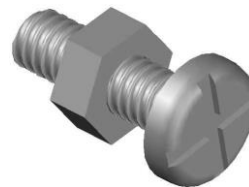
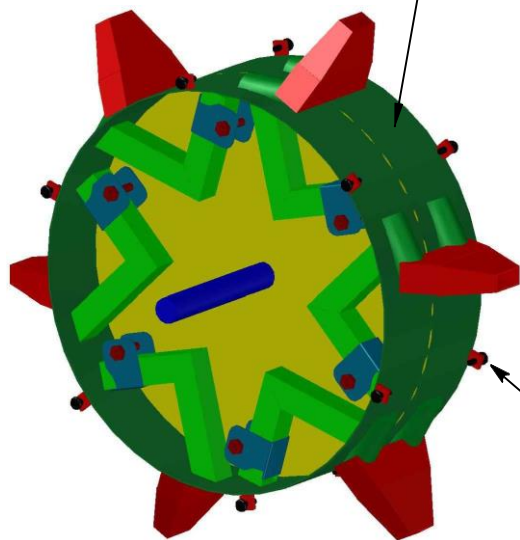

FERTISEEDER 2



	Drawn	Mahefa Rasoloharison		Rolling injection seeder	
	Mail	maahefarivo@gmail.com	04/05/20	Material	Weight (kg)
Scale :				DRAWING N° : 003	
		Name	Date		